**ZKLFA0640-2Z**

Axial angular contact ball bearing

Angular contact ball bearing units
ZKLFA.-2Z, double direction, for screw
mounting, gap seals on both sides

Technical information

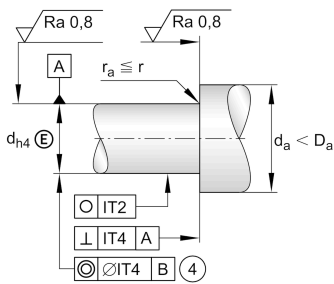
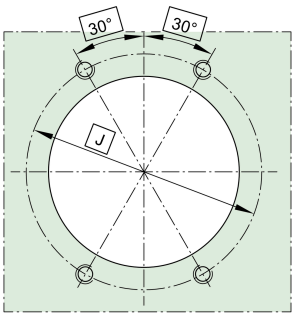
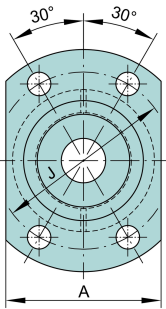

Your current product variant

Type of Seal	2Z	Minimal gap seal on both sides
--------------	----	--------------------------------

Main Dimensions & Performance Data

d	6 mm	Bore diameter
	0,002 mm	Bore diameter upper tolerance
	-0,003 mm	Bore diameter lower tolerance
D	24 mm	Outside diameter
	0 mm	Outside diameter upper tolerance
	-0,01 mm	Outside diameter lower tolerance
B	15 mm	Width
	0 mm	Width upper tolerance
	-0,25 mm	Width lower tolerance
C _a	6.900 N	Basic dynamic load rating, axial
C _{0a}	8.500 N	Basic static load rating, axial
C _{ua}	385 N	Fatigue load limit, axial
n _G Grease	19.900 1/min	Limiting speed for grease lubrication
n _g	12.000 1/min	Thermally permissible speed
≈m	59 g	Weight

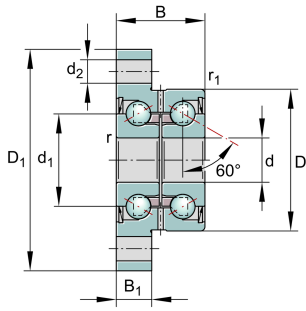

Mounting dimensions

$d_{a \min}$	9 mm	Minimum diameter shaft shoulder
$d_{a \max}$	18 mm	Maximum diameter of shaft shoulder
t_1	0,1 mm	Position tolerance
	M4	Screw size

n_a	4	Number of screws
-------	---	------------------

Dimensions

d_1	14 mm	Rib diameter inner ring
-------	-------	-------------------------

r_{\min}	0,3 mm	Minimum chamfer dimension
------------	--------	---------------------------

$r_{1 \min}$	0,6 mm	Minimum chamfer dimension
--------------	--------	---------------------------

B_1	6 mm	Thickness of flange
-------	------	---------------------

d_2	4,5 mm	Fixing boring diameter
-------	--------	------------------------

J	32 mm	Pitch circle diameter (holes)
---	-------	-------------------------------

A	27 mm	Flange width
---	-------	--------------

Temperature range

T_{\min}	-30 °C	Operating temperature min.
------------	--------	----------------------------

T_{\max}	120 °C	Operating temperature max.
------------	--------	----------------------------

Additional information

M_{RL}	0,02 Nm	Bearing friction torque
----------	---------	-------------------------

c_{aL}	200 N/ μ m	Rigidity axial
----------	----------------	----------------

c_{kL}	8 Nm/mrad	Tilting stiffness
----------	-----------	-------------------

M_m	0,004 kg \cdot cm ²	Mass moment of inertia
-------	----------------------------------	------------------------

	2 μ m	Axial runout
--	-----------	--------------

	ZM06	Recommended INA precision locknut for radial locking (not included)
--	------	---

M_A	2 Nm	Tightening torque nut
-------	------	-----------------------

	2.404 N	Locknut force axial
--	---------	---------------------



Characteristics



Radial load



Axial load in one direction



Axial load in two directions



Lifetime lubrication, freedom from maintenance



Grease Lubrication



Sealed on both sides