

**81288-M**

Axial cylindrical roller bearing

Axial cylindrical roller bearing 812...-M, single row

Technical information

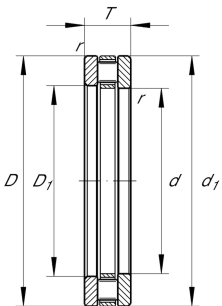

Your current product variant

Cage	M	Brass Cage
------	---	------------

Main Dimensions & Performance Data

d	440 mm	Bore diameter
T	130 mm	Height
C _a	3.550.000 N	Basic dynamic load rating, axial
C _{0a}	14.400.000 N	Basic static load rating, axial
C _{ua}	1.040.000 N	Fatigue load limit, axial
n _G	550 1/min	Limiting speed
n _{gr}	163 1/min	Reference speed
D	600 mm	Outside diameter
≈m	118 kg	Weight

Mounting dimensions

d _{a min}	591 mm	Minimum diameter shaft shoulder
D _{a max}	479 mm	Maximum diameter of housing shoulder
r _{a max}	5 mm	Maximum recess radius

Dimensions

D ₁	445 mm	Bore diameter housing washer
d ₁	595 mm	Rip diameter shaft washer
r _{min}	5 mm	Minimum chamfer dimension



Temperature range

T_{min}	-30 °C	Operating temperature min.
T_{max}	120 °C	Operating temperature max.

Additional information

K81288-M	Axial roller and cage assembly
GS81288	Housing Washer
WS81288	Shaft washer

Characteristics

-  Axial load in one direction
-  Grease Lubrication
-  Oil Lubrication
-  Not sealed