

**81212-TV** [↗](#)

Axial cylindrical roller bearing

Axial cylindrical roller bearings 874, single direction, comprising K874, GS, WS

Technical information

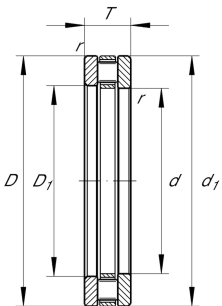

Your current product variant

Cage	TV	Plastic Cage made from PA66
------	----	-----------------------------

Main Dimensions & Performance Data

d	60 mm	Bore diameter
T	26 mm	Height
C _a	173.000 N	Basic dynamic load rating, axial
C _{0a}	480.000 N	Basic static load rating, axial
C _{ua}	46.500 N	Fatigue load limit, axial
n _G	3.700 1/min	Limiting speed
n _{gr}	1.300 1/min	Reference speed
D	95 mm	Outside diameter
≈m	0,642 kg	Weight

Mounting dimensions

d _{a min}	91 mm	Minimum diameter shaft shoulder
D _{a max}	64 mm	Maximum diameter of housing shoulder
r _{a max}	1 mm	Maximum recess radius

Dimensions

D ₁	62 mm	Bore diameter housing washer
d ₁	95 mm	Rip diameter shaft washer
r _{min}	1 mm	Minimum chamfer dimension



Temperature range

T_{min}	-30 °C	Operating temperature min.
T_{max}	120 °C	Operating temperature max.

Additional information

K81212-TV	Axial roller and cage assembly
GS81212	Housing Washer
WS81212	Shaft washer
LS7095	Track Washer

Characteristics

-  Axial load in one direction
-  Grease Lubrication
-  Oil Lubrication
-  Not sealed