

**NKXR35-Z-XL**

## Needle roller/axial cylindrical roller bearing

Needle roller/axial cylindrical roller bearings  
NKXR...-Z, axial component, single direction,  
to DIN 5429, with end cap, for grease  
lubrication

X-life

## Technical information

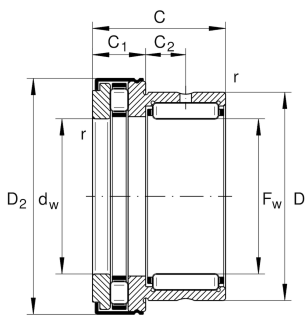
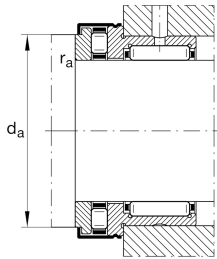

## Your current product variant

Sealing	Z	Bearing with end cap
Tolerance class	PN	Normal (DIN 620-2)

## Main Dimensions &amp; Performance Data

$F_w$	35 mm	Bore diameter
D	47 mm	Outside diameter
C	30 mm	Height
$C_r$	27.500 N	Basic dynamic load rating, radial
$C_{0r}$	41.500 N	Basic static load rating, radial
$C_a$	39.000 N	Basic dynamic load rating, axial
$C_{0a}$	101.000 N	Basic static load rating, axial
$C_{ur}$	7.400 N	Fatigue load limit, radial
$C_{ua}$	9.600 N	Fatigue load limit, axial
$n_G$	6.500 1/min	Limiting speed
$n_{gr}$	2.500 1/min	Reference speed
$\approx m$	164,52 g	Weight

## Mounting dimensions

$d_a$	47,7 mm	Mounting dimension shaft shoulder
$r_{a \max}$	0,6 mm	Maximum recess radius



### Dimensions

D 2 max	53,2 mm	Maximum outside diameter flange
C 1	12 mm	Width of the axial bearing component
C 2	9 mm	Distance to lubrication hole
d <sub>w</sub>	35 mm	Bore diameter of shaft washer
r <sub>min</sub>	0,6 mm	Minimum chamfer dimension



### Temperature range

T <sub>min</sub>	-30 °C	Operating temperature min.
T <sub>max</sub>	120 °C	Operating temperature max.

### Additional information

IR30X35X20-XL	Suitable inner rings IR
---------------	-------------------------

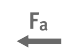
### Characteristics

-  Radial load
-  Axial load in one direction
-  Grease Lubrication
-  Sealed on one side