



## ZARF2068-TV

Needle roller/axial cylindrical roller bearing

Needle roller/axial cylindrical roller bearings  
ZARF, double direction, for screw mounting

### Technical information

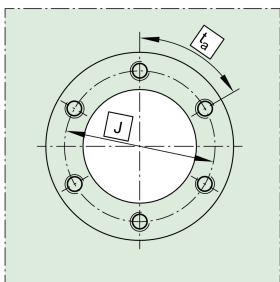
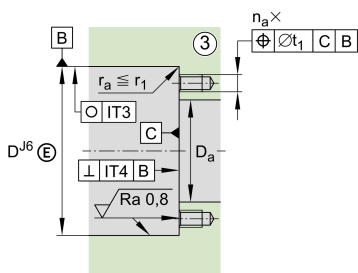
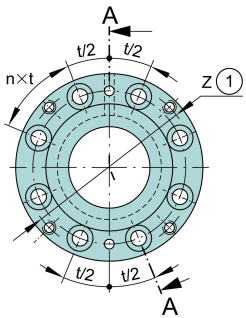

### Your current product variant

Cage	TV	Plastic Cage made from PA66
------	----	-----------------------------

### Main Dimensions & Performance Data

d	20 mm	Bore diameter
D	68 mm	Outside diameter
H	46 mm	Height
C <sub>a</sub>	33.500 N	Basic dynamic load rating, axial
C <sub>0a</sub>	76.000 N	Basic static load rating, axial
C <sub>r</sub>	14.900 N	Basic dynamic load rating, radial
C <sub>0r</sub>	22.400 N	Basic static load rating, radial
C <sub>ua</sub>	6.400 N	Fatigue load limit, axial
C <sub>ur</sub>	3.400 N	Fatigue load limit, radial
n <sub>G Oil</sub>	7.000 1/min	Limiting speed for oil lubrication
n <sub>G Grease</sub>	2.000 1/min	Limiting speed for grease lubrication
M <sub>RL</sub>	0,5 Nm	Bearing friction torque
≈m	0,495 kg	Weight

### Mounting dimensions

D <sub>a max</sub>	43 mm	Maximum diameter of housing shoulder
d <sub>a min</sub>	33 mm	Minimum diameter shaft shoulder
t <sub>1</sub>	0,1 mm	Position bore in the housing



## Dimensions

H <sub>1</sub>	29 mm	Height outer ring over wave washer
C	14 mm	Width, outer ring
C <sub>1</sub>	8 mm	Distance to lubrication hole
D <sub>1</sub>	42 mm	Rip diameter shaft washer
B	10 mm	Width inner ring
r <sub>min</sub>	0,3 mm	Minimum chamfer dimension
r <sub>1 min</sub>	0,6 mm	Minimum chamfer dimension
d <sub>1</sub>	3,2 mm	Diameter lubrication hole
J	53 mm	Pitch circle diameter (holes)
n	8	Number of screwing holes
n x t	45 °	Split

## Temperature range







T <sub>min</sub>	-30 °C	Operating temperature min.
T <sub>max</sub>	120 °C	Operating temperature max.



### Additional information

$c_{aL}$	1.800 N/ $\mu$ m	Rigidity axial
$c_{kL}$	230 Nm/mrad	Tilting stiffness
$M_m$	0,615 kg*cm <sup>2</sup>	Mass moment of inertia
	1 $\mu$ m	Axial runout
radial	ZMA20/38	Recommended INA precision locknut for radial locking (not included)
axial	AM20	Recommended INA precision locknut for axial locking (not included)
$M_A$	18 Nm	Tightening torque nut
	8.972 N	Required locknut force
	M6	Screw size
$n_a$	8	Number of screws
na x ta	45 °	Division (screwing holes)

### Characteristics

-  Radial load
-  Axial load in one direction
-  Axial load in two directions
-  Grease Lubrication
-  Oil Lubrication
-  Not sealed