

ZARF2575-TV

Needle roller/axial cylindrical roller bearing

Needle roller/axial cylindrical roller bearings
ZARF, double direction, for screw mounting

Technical information

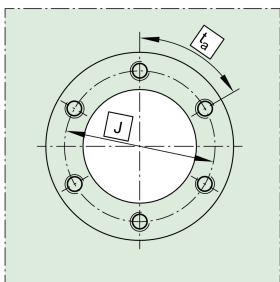
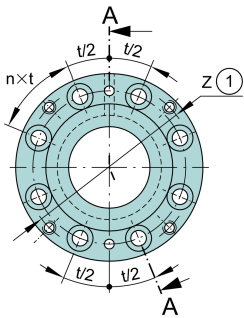
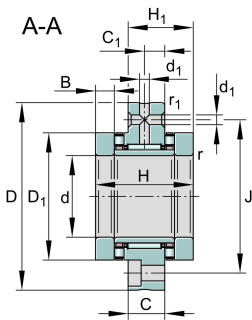

Your current product variant

Cage	TV	Plastic Cage made from PA66
------	----	-----------------------------

Main Dimensions & Performance Data

d	25 mm	Bore diameter
D	75 mm	Outside diameter
H	50 mm	Height
C _a	35.500 N	Basic dynamic load rating, axial
C _{0a}	86.000 N	Basic static load rating, axial
C _r	22.600 N	Basic dynamic load rating, radial
C _{0r}	36.000 N	Basic static load rating, radial
C _{ua}	7.300 N	Fatigue load limit, axial
C _{ur}	5.200 N	Fatigue load limit, radial
n _{G Oil}	6.000 1/min	Limiting speed for oil lubrication
n _{G Grease}	1.900 1/min	Limiting speed for grease lubrication
M _{RL}	0,55 Nm	Bearing friction torque
≈m	0,701 kg	Weight

Mounting dimensions

D _{a max}	48 mm	Maximum diameter of housing shoulder
d _{a min}	39 mm	Minimum diameter shaft shoulder
t ₁	0,1 mm	Position bore in the housing



Dimensions

H ₁	33 mm	Height outer ring over wave washer
C	18 mm	Width, outer ring
C ₁	10 mm	Distance to lubrication hole
D ₁	47 mm	Rip diameter shaft washer
B	10 mm	Width inner ring
r _{min}	0,3 mm	Minimum chamfer dimension
r _{1 min}	0,6 mm	Minimum chamfer dimension
d ₁	3,2 mm	Diameter lubrication hole
J	58 mm	Pitch circle diameter (holes)
n	8	Number of screwing holes
n x t	45 °	Split

Temperature range







T _{min}	-30 °C	Operating temperature min.
T _{max}	120 °C	Operating temperature max.



Additional information

c_{aL}	1.900 N/ μ m	Rigidity axial
c_{kL}	350 Nm/mrad	Tilting stiffness
M_m	0,989 kg*cm ²	Mass moment of inertia
	1 μ m	Axial runout
radial	ZMA25/45	Recommended INA precision locknut for radial locking (not included)
axial	AM25	Recommended INA precision locknut for axial locking (not included)
M_A	25 Nm	Tightening torque nut
	9.745 N	Required locknut force
	M6	Screw size
n_a	8	Number of screws
na x ta	45 °	Division (screwing holes)

Characteristics

-  Radial load
-  Axial load in one direction
-  Axial load in two directions
-  Grease Lubrication
-  Oil Lubrication
-  Not sealed