



ZARF2590-TV

Needle roller/axial cylindrical roller bearing

Needle roller/axial cylindrical roller bearings
ZARF, double direction, for screw mounting

Technical information

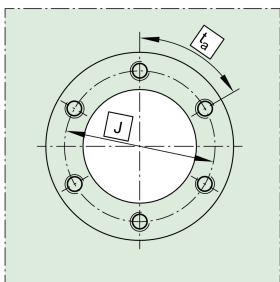

Your current product variant

| | | |
|------|----|-----------------------------|
| Cage | TV | Plastic Cage made from PA66 |
|------|----|-----------------------------|

Main Dimensions & Performance Data

| | | |
|-----------------------|-------------|---------------------------------------|
| d | 25 mm | Bore diameter |
| D | 90 mm | Outside diameter |
| H | 60 mm | Height |
| C _a | 80.000 N | Basic dynamic load rating, axial |
| C _{0a} | 199.000 N | Basic static load rating, axial |
| C _r | 24.300 N | Basic dynamic load rating, radial |
| C _{0r} | 41.500 N | Basic static load rating, radial |
| C _{ua} | 18.600 N | Fatigue load limit, axial |
| C _{ur} | 6.000 N | Fatigue load limit, radial |
| n _{G Oil} | 4.900 1/min | Limiting speed for oil lubrication |
| n _{G Grease} | 1.400 1/min | Limiting speed for grease lubrication |
| M _{RL} | 1,6 Nm | Bearing friction torque |
| ≈m | 1,36 kg | Weight |

Mounting dimensions

| | | |
|--------------------|--------|--------------------------------------|
| D _{a max} | 63 mm | Maximum diameter of housing shoulder |
| d _{a min} | 45 mm | Minimum diameter shaft shoulder |
| t ₁ | 0,1 mm | Position bore in the housing |



Dimensions

| | | |
|--------------------|---------|------------------------------------|
| H ₁ | 38 mm | Height outer ring over wave washer |
| C | 18 mm | Width, outer ring |
| C ₁ | 10 mm | Distance to lubrication hole |
| D ₁ | 62 mm | Rip diameter shaft washer |
| B | 12,5 mm | Width inner ring |
| r _{min} | 0,3 mm | Minimum chamfer dimension |
| r _{1 min} | 0,6 mm | Minimum chamfer dimension |
| d ₁ | 3,2 mm | Diameter lubrication hole |
| J | 73 mm | Pitch circle diameter (holes) |
| n | 12 | Number of screwing holes |
| n x t | 30 ° | Split |

Temperature range







| | | |
|------------------|--------|----------------------------|
| T _{min} | -30 °C | Operating temperature min. |
| T _{max} | 120 °C | Operating temperature max. |



Additional information

| | | |
|------------|-------------------------|---|
| c_{aL} | 3.000 N/ μ m | Rigidity axial |
| c_{kL} | 800 Nm/mrad | Tilting stiffness |
| M_m | 3,88 kg*cm ² | Mass moment of inertia |
| | 1 μ m | Axial runout |
| radial | ZMA25/58 | Recommended INA precision locknut for radial locking (not included) |
| axial | AM25 | Recommended INA precision locknut for axial locking (not included) |
| M_A | 55 Nm | Tightening torque nut |
| | 20.790 N | Required locknut force |
| | M6 | Screw size |
| n_a | 12 | Number of screws |
| n_{axta} | 30 ° | Division (screwing holes) |

Characteristics

-  Radial load
-  Axial load in one direction
-  Axial load in two directions
-  Grease Lubrication
-  Oil Lubrication
-  Not sealed