



## ZARF1762-L-TV

Needle roller/axial cylindrical roller bearing

Needle roller/axial cylindrical roller bearings  
ZARF..-L, double direction, for screw  
mounting, long shaft locating washer

### Technical information

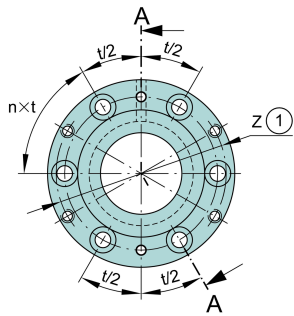

### Your current product variant

Cage	TV	Plastic Cage made from PA66
Locating Feature , bearing outer ring	L	Stepped shaft locating washer extended on one side

### Main Dimensions & Performance Data

d	17 mm	Bore diameter
D	62 mm	Outside diameter
H	57 mm	Hight
C <sub>a</sub>	26.000 N	Basic dynamic load rating, axial
C <sub>0a</sub>	57.000 N	Basic static load rating, axial
C <sub>r</sub>	14.000 N	Basic dynamic load rating, radial
C <sub>0r</sub>	19.900 N	Basic static load rating, radial
C <sub>ua</sub>	8.000 N	Fatigue load limit, axial
C <sub>ur</sub>	3.000 N	Fatigue load limit, radial
n <sub>G Oil</sub>	7.800 1/min	Limiting speed for oil lubrication
n <sub>G Grease</sub>	2.100 1/min	Limiting speed for grease lubrication
M <sub>RL</sub>	0,4 Nm	Bearing friction torque
≈m	0,458 kg	Weight

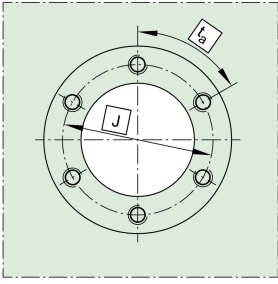

### Mounting dimensions

$D_{a \max}$	39 mm	Maximum diameter of housing shoulder
$d_{a \min}$	26 mm	Minimum diameter shaft shoulder
$t_1$	0,1 mm	Position bore in the housing

### Dimensions

$H_1$	41,5 mm	Height outer ring over wave washer
C	14 mm	Width, outer ring
$C_1$	8 mm	Distance to lubrication hole
$D_1$	38 mm	Rip diameter shaft washer
$D_2$	28 mm	Heeldiameter wave washer long
$D_3$	38 mm	Outside diameter wave washer long
B	9 mm	Width, wave washer
$B_1$	23 mm	Width wave washer long
$B_2$	11 mm	Width heel wave washer long
$r_{\min}$	0,3 mm	Minimum chamfer dimension
$r_{1 \min}$	0,6 mm	Minimum chamfer dimension
$d_1$	3,2 mm	Diameter lubrication hole
J	48 mm	Pitch circle diameter (holes)
n	6	Number of screwing holes
$n \times t$	60 °	Split

### Temperature range





$T_{\min}$	-30 °C	Operating temperature min.
$T_{\max}$	120 °C	Operating temperature max.

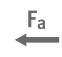
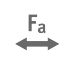

### Additional information

$c_{aL}$	1.600 N/ $\mu$ m	Rigidity axial
$c_{kL}$	160 Nm/mrad	Tilting stiffness
$M_m$	0,464 kg*cm <sup>2</sup>	Mass moment of inertia
	1 $\mu$ m	Axial runout
radial	ZM17	Recommended INA precision locknut for radial locking (not included)
axial	AM17	Locknut 2
$M_A$	12 Nm	Tightening torque nut
	7.078 N	Preload force axial
	28X40X7	Sealing ring
	M6	Screw size
$n_a$	6	Number of screws
$n_{axta}$	60 °	Division (screwing holes)

### Characteristics

-  Radial load
-  Axial load in one direction
-  Axial load in two directions
-  Grease Lubrication
-  Oil Lubrication
-  Not sealed