

**ZARF2068-L-TV**

Needle roller/axial cylindrical roller bearing

Needle roller/axial cylindrical roller bearings
ZARF..-L, double direction, for screw
mounting, long shaft locating washer

Technical information

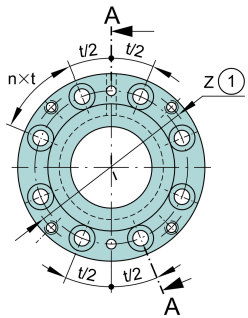

Your current product variant

Cage	TV	Plastic Cage made from PA66
Locating Feature , bearing outer ring	L	Stepped shaft locating washer extended on one side

Main Dimensions & Performance Data

d	20 mm	Bore diameter
D	68 mm	Outside diameter
H	60 mm	Hight
C _a	33.500 N	Basic dynamic load rating, axial
C _{0a}	76.000 N	Basic static load rating, axial
C _r	14.900 N	Basic dynamic load rating, radial
C _{0r}	22.400 N	Basic static load rating, radial
C _{ua}	6.400 N	Fatigue load limit, axial
C _{ur}	3.400 N	Fatigue load limit, radial
n _{G Oil}	7.000 1/min	Limiting speed for oil lubrication
n _{G Grease}	2.000 1/min	Limiting speed for grease lubrication
M _{RL}	0,5 Nm	Bearing friction torque
≈m	0,534 kg	Weight

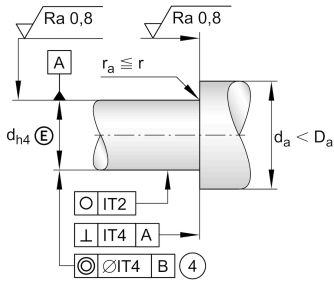
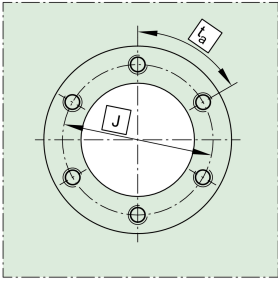

Mounting dimensions

$D_{a \max}$	43 mm	Maximum diameter of housing shoulder
$d_{a \min}$	28 mm	Minimum diameter shaft shoulder
t_1	0,1 mm	Position bore in the housing

Dimensions

H_1	43 mm	Height outer ring over wave washer
C	14 mm	Width, outer ring
C_1	8 mm	Distance to lubrication hole
D_1	42 mm	Rip diameter shaft washer
D_2	30 mm	Heeldiameter wave washer long
D_3	40 mm	Outside diameter wave washer long
B	10 mm	Width, wave washer
B_1	24 mm	Width wave washer long
B_2	12 mm	Width heel wave washer long
r_{\min}	0,3 mm	Minimum chamfer dimension
$r_{1 \min}$	0,6 mm	Minimum chamfer dimension
d_1	3,2 mm	Diameter lubrication hole
J	53 mm	Pitch circle diameter (holes)
n	8	Number of screwing holes
$n \times t$	45 °	Split

Temperature range





T_{\min}	-30 °C	Operating temperature min.
T_{\max}	120 °C	Operating temperature max.

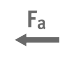
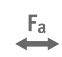

Additional information

c_{aL}	1.800 N/ μ m	Rigidity axial
c_{kL}	230 Nm/mrad	Tilting stiffness
M_m	0,683 kg*cm ²	Mass moment of inertia
	1 μ m	Axial runout
radial	ZMA20/38	Recommended INA precision locknut for radial locking (not included)
axial	AM20	Locknut 2
M_A	18 Nm	Tightening torque nut
	8.972 N	Preload force axial
	30X42X7	Sealing ring
	M6	Screw size
n_a	8	Number of screws
$n_{a \times ta}$	45 °	Division (screwing holes)

Characteristics

	Radial load
	Axial load in one direction
	Axial load in two directions
	Grease Lubrication
	Oil Lubrication
	Not sealed