

**ZARF75185-L-TV**

Needle roller/axial cylindrical roller bearing

Needle roller/axial cylindrical roller bearings
ZARF..-L, double direction, for screw
mounting, long shaft locating washer

Technical information

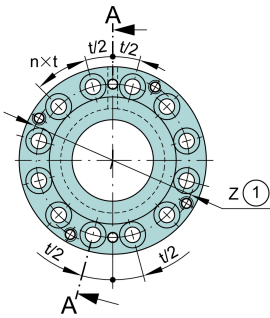

Your current product variant

Cage	TV	Plastic Cage made from PA66
Locating Feature , bearing outer ring	L	Stepped shaft locating washer extended on one side

Main Dimensions & Performance Data

d	75 mm	Bore diameter
D	185 mm	Outside diameter
H	125 mm	Hight
C _a	290.000 N	Basic dynamic load rating, axial
C _{0a}	890.000 N	Basic static load rating, axial
C _r	81.000 N	Basic dynamic load rating, radial
C _{0r}	132.000 N	Basic static load rating, radial
C _{ua}	85.000 N	Fatigue load limit, axial
C _{ur}	19.100 N	Fatigue load limit, radial
n _{G Oil}	2.100 1/min	Limiting speed for oil lubrication
n _{G Grease}	700 1/min	Limiting speed for grease lubrication
M _{RL}	8 Nm	Bearing friction torque
≈m	10,016 kg	Weight

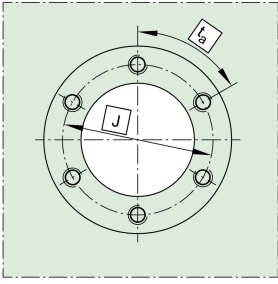

Mounting dimensions

$D_{a \max}$	136 mm	Maximum diameter of housing shoulder
$d_{a \min}$	110 mm	Minimum diameter shaft shoulder
t_1	0,4 mm	Position bore in the housing

Dimensions

H_1	87 mm	Height outer ring over wave washer
C	27 mm	Width, outer ring
C_1	15 mm	Distance to lubrication hole
D_1	135 mm	Rip diameter shaft washer
D_2	115 mm	Heeldiameter wave washer long
D_3	135 mm	Outside diameter wave washer long
B	21 mm	Width, wave washer
B_1	46 mm	Width wave washer long
B_2	20 mm	Width heel wave washer long
r_{\min}	0,3 mm	Minimum chamfer dimension
$r_{1 \min}$	1 mm	Minimum chamfer dimension
d_1	6 mm	Diameter lubrication hole
J	155 mm	Pitch circle diameter (holes)
n	12	Number of screwing holes
$n \times t$	30 °	Split

Temperature range







T_{\min}	-30 °C	Operating temperature min.
T_{\max}	120 °C	Operating temperature max.



Additional information

c_{aL}	6.600 N/ μ m	Rigidity axial
c_{kL}	8.500 Nm/mrad	Tilting stiffness
M_m	188 kg*cm ²	Mass moment of inertia
	2 μ m	Axial runout
radial	ZMA75/125	Recommended INA precision locknut for radial locking (not included)
axial	AM75	Locknut 2
M_A	580 Nm	Tightening torque nut
	72.971 N	Preload force axial
	115X140X12	Sealing ring
	M12	Screw size
n_a	12	Number of screws
n_{axta}	30 °	Division (screwing holes)

Characteristics

	Radial load
	Axial load in one direction
	Axial load in two directions
	Grease Lubrication
	Oil Lubrication
	Not sealed