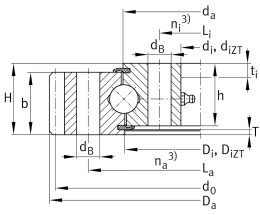
**VA160235-N-ZT** [↗](#)

Slewing ring, 4 point contact bearing, external gear teeth

Slewing ring, 4 point contact bearing, external gear teeth

Technical information

**Your current product variant**

Centering	ZT	Centering on inner and outer ring
Gearing	N	Normalized gear teeth on bearing ring

Main Dimensions & Performance Data

d_i	171 mm	Bore Diameter
d_{iZT}	173 mm	Diameter centring inner ring
	IT8	Diameter centring inner ring tolerance
H	40 mm	Height
D_a	318,6 mm	Outside Diameter
D_{iZT}	236 mm	Diameter centring outer ring
	IT8	Diameter centring outer ring tolerance
T	2,3 mm	Length centering outer ring
t	6 mm	Length centering inner ring
h_a	35 mm	Width outer ring
h_i	35 mm	Height of inner ring
	0,04 mm	Normal radial clearance min.
	0,16 mm	Normal radial clearance max.
	0,07 mm	Normal axial clearance min.
	0,26 mm	Normal axial clearance max.
$\approx m$	12,9 kg	Weight



Dimensions

D_i	234 mm	Inner diameter outer ring
d_a	236 mm	Outside diameter inner ring
n_i	12	Number of fixing holes in inner ring
L_i	195 mm	Pitchcircle diameter fixing holes inner ring
d_B	13 mm	Fixing bore
n_a	12	Number of fixing holes in outer ring
L_a	275 mm	Pitchcircle diameter fixing holes outer ring
$F_{r\ zul}$	63.000 N	Max. radial load fixing screws (friction locking)
d_0	312 mm	Pitch circle diameter gearing
m	4 mm	Modul of gearing
z	78	Number of teeth
b	35 mm	Width gearing
$F_{z\ norm}$	11.000 N	Max. tooth force root fatigue strenght (at a shock factor of 1,2)
$F_{z\ max}$	16.100 N	Max. tooth force against tooth fracture (at a shock factor of 1,35)

Temperature range

T_{min}	-25 °C	Operating temperature min.
T_{max}	80 °C	Operating temperature max.

Calculation factors

C_a	123.000 N	Basic dynamic load rating, axial
C_{0a}	460.000 N	Basic static load rating, axial
C_r	112.000 N	Basic dynamic load rating, radial
C_{0r}	210.000 N	Basic static load rating, radial



Characteristics



Radial load



Axial load in one direction



Axial load in two directions



Moments about all axes



Grease Lubrication