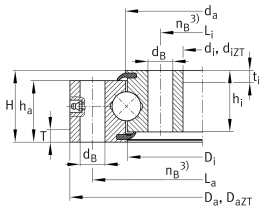

**VSU250755** [↗](#)

Slewing ring, 4 point contact bearing, without gear teeth

Slewing Ring, Four Point contact bearing,
without gear teeth

Technical information

**Main Dimensions & Performance Data**

d_i	655 mm	Inner diameter inner ring
H	63 mm	Height
D_a	855 mm	Outside Diameter
h_a	54 mm	Width outer ring
h_i	54 mm	Width inner ring
	0,03 mm	Normal radial clearance min.
	0,13 mm	Normal radial clearance max.
	0,05 mm	Normal axial clearance min.
	0,24 mm	Normal axial clearance max.
$\approx m$	89,06 kg	Weight

Dimensions

D_i	753 mm	Inner diameter outer ring
d_a	757 mm	Outside diameter inner ring
d_B	22 mm	Fixing bore
L_a	815 mm	Pitchcircle diameter fixing holes outer ring
n_a	24	Number of fixing holes in outer ring
L_i	695 mm	Pitchcircle diameter fixing holes inner ring
n_i	24	Number of fixing holes in inner ring
$F_{r\text{ zul}}$	290.400 N	Max. radial load fixing screws (friction locking)









Temperature range

T_{min}	-25 °C	Operating temperature min.
T_{max}	80 °C	Operating temperature max.

Calculation factors

C_a	340.000 N	Basic dynamic load rating, axial
C_{0a}	2.700.000 N	Basic static load rating, axial
C_r	305.000 N	Basic dynamic load rating, radial (for radial load only)
C_{0r}	1.230.000 N	Basic static load rating, radial (for radial load only)

Characteristics

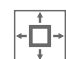
-  Radial load
-  Axial load in one direction
-  Axial load in two directions
-  Moments about all axes
-  Grease Lubrication
-  Sealed on both sides
-  Large bearing