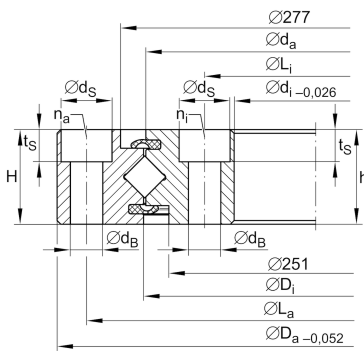

**XU080264** [↗](#)

Slewing ring, Crossed roller bearing, without gear teeth

Crossed roller bearings without gear teeth,  
sealed on both sides

## Technical information

**Main Dimensions & Performance Data**

$d_i$	215,9 mm	Bore Diameter
	0 mm	Bore diameter upper tolerance
	-0,026 mm	Bore diameter lower tolerance
$D_a$	311 mm	Outside Diameter
	0 mm	Outside diameter upper tolerance
	-0,052 mm	Outside diameter lower tolerance
H	25,4 mm	Height
≈m	6,7 kg	Weight



## Dimensions

$D_i$	264,6 mm	Inner diameter outer ring
$h_a$	25,4 mm	Height outer ring
$L_a$	295,3 mm	Pitchcircle diameter fixing holes outer ring
$n_a$	12	Number of fixing holes in outer ring
$d_a$	263,4 mm	Outside diameter inner ring
$h_i$	25,4 mm	Height of inner ring
$d_B$	8,7 mm	Fixing bore
$d_S$	13,7 mm	Counterbore diameter of fixing holes
$t_S$	8,6 mm	Counterbore depth of fixing holes
$L_j$	231,8 mm	Pitchcircle diameter fixing holes inner ring
$n_j$	12	Number of fixing holes in inner ring
VSP <sub>min</sub>	0 mm	Min. bearing preload
VSP <sub>max</sub>	0,02 mm	Maximum bearing preload

## Temperature range

$T_{min}$	-30 °C	Operating temperature min.
$T_{max}$	80 °C	Operating temperature max.

## Calculation factors

$C_a$	79.000 N	Basic dynamic load rating, axial
$C_r$	56.000 N	Basic dynamic load rating, radial (for radial load only)
$C_{0a}$	148.000 N	Basic static load rating, axial
$C_{0r}$	73.000 N	Basic static load rating, radial (for radial load only)
$F_{rzu}$	21.000 N	Max. radial load screws



### Characteristics

---



Radial load



Axial load in one direction



Axial load in two directions



Moments about all axes



Grease Lubrication



Sealed on both sides