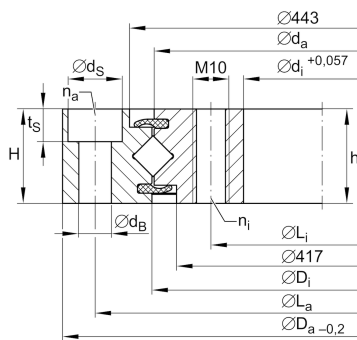

**XU080430**

Slewing ring, Crossed roller bearing, without gear teeth

Crossed roller bearings without gear teeth,
sealed on both sides

Technical information

**Main Dimensions & Performance Data**

d_i	380 mm	Bore Diameter
	0,057 mm	Bore diameter upper tolerance
	0 mm	Bore diameter lower tolerance
D_a	480 mm	Outside Diameter
	0 mm	Outside diameter upper tolerance
	-0,2 mm	Outside diameter lower tolerance
H	26 mm	Height
$\approx m$	11,925 kg	Weight



Dimensions

D_i	430,6 mm	Inner diameter outer ring
L_a	462 mm	Pitchcircle diameter fixing holes outer ring
n_a	20	Number of fixing holes in outer ring
d_a	429,4 mm	Outside diameter inner ring
h_i	26 mm	Height of inner ring
d_B	9 mm	Fixing bore
d_S	15 mm	Counterbore diameter of fixing holes
t_S	9 mm	Counterbore depth of fixing holes
L_j	398 mm	Pitchcircle diameter fixing holes inner ring
n_j	20	Number of fixing holes in inner ring
	M10	Tread fixing bore
VSP _{min}	0,005 mm	Min. bearing preload
VSP _{max}	0,02 mm	Maximum bearing preload

Temperature range

T_{min}	-30 °C	Operating temperature min.
T_{max}	80 °C	Operating temperature max.

Calculation factors

C_a	96.000 N	Basic dynamic load rating, axial
C_r	68.000 N	Basic dynamic load rating, radial (for radial load only)
C_{0a}	345.000 N	Basic static load rating, axial
C_{0r}	168.000 N	Basic static load rating, radial (for radial load only)
$F_{rzu.}$	35.000 N	Max. radial load screws



Characteristics



Radial load



Axial load in one direction



Axial load in two directions



Moments about all axes



Grease Lubrication



Sealed on both sides



Large bearing