**XU160260-ZT** [↗](#)

Slewing ring, Crossed roller bearing, without gear teeth

Crossed roller bearings without gear teeth,
sealed on both sides

Technical information

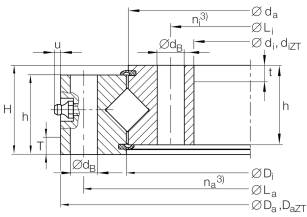

Your current product variant

Centering	ZT	Centering on inner and outer ring
-----------	----	-----------------------------------

Main Dimensions & Performance Data

d_i	191 mm	Bore Diameter
d_{iZT}	193 mm	Diameter centring inner ring
	IT8	Diameter centring inner ring tolerance
t	7 mm	Length centering inner ring
D_a	329 mm	Outside Diameter
D_{aZT}	327 mm	Diameter centring outer ring
	-IT8	Diameter centring outer ring tolerance
T	7 mm	Length centering outer ring
H	46 mm	Height
$\approx m$	15,2 kg	Weight



Dimensions

D_i	261 mm	Inner diameter outer ring
h_a	41 mm	Height outer ring
L_a	305 mm	Pitchcircle diameter fixing holes outer ring
n_a	20	Number of fixing holes in outer ring
d_a	259 mm	Outside diameter inner ring
h_i	41 mm	Height of inner ring
d_B	14 mm	Fixing bore
L_i	215 mm	Pitchcircle diameter fixing holes inner ring
n_i	20	Number of fixing holes in inner ring
u_{max}	3,5 mm	Max. protrusion lubrication nipple
VSP _{min}	0 mm	Min. bearing preload
VSP _{max}	0,02 mm	Maximum bearing preload

Temperature range

T_{min}	-30 °C	Operating temperature min.
T_{max}	80 °C	Operating temperature max.

Calculation factors

C_a	198.000 N	Basic dynamic load rating, axial
C_r	141.000 N	Basic dynamic load rating, radial (for radial load only)
C_{0a}	405.000 N	Basic static load rating, axial
C_{0r}	199.000 N	Basic static load rating, radial (for radial load only)
$F_{rzu.}$	78.000 N	Max. radial load screws



Characteristics



Radial load



Axial load in one direction



Axial load in two directions



Moments about all axes



Grease Lubrication



Sealed on both sides



Large bearing