**RSTO6-TV**

Yoke type track roller

Yoke type track rollers RSTO..., single row needle roller bearings with particularly thick-walled outer ring, needle roller and cage assembly, without inner ring, without axial guidance of the outer ring, open, inner ring, outer ring and needle roller and cage assembly can be mounted separately

Technical information

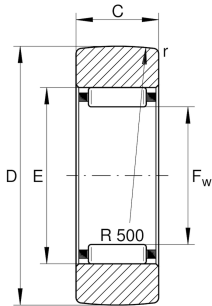

Your current product variant

Type of Seal	Without	
Outer ring profile	R500	R500
Cage	TV	Plastic Cage made from PA66

Main Dimensions & Performance Data

D	19 mm	Outside diameter
F _w	10 mm	Under roller diameter
C	9,8 mm	Width, outer ring
C _{r w}	3.750 N	Basic dynamic load rating, radial
C _{0r w}	4.600 N	Basic static load rating, radial
C _{ur w}	660 N	Fatigue load limit, radial
n _{D G}	10.000 1/min	Speed on permanent grease lubrication
≈m	12,96 g	Weight

Dimensions

E	13 mm	Raceway diameter outer ring
r _{min}	0,3 mm	Minimum chamfer dimension
R	500 mm	Radius of outer ring outside profile



Characteristics



Radial load



Grease Lubrication



Oil Lubrication



Not sealed