

**NATR15-PP**

Yoke type track roller

Yoke type track rollers NATR...-PP-A, single row needle roller bearings with particularly thick-walled outer ring, needle roller and cage assembly and an inner ring, axial guidance of outer ring is provided by the plastic axial plain washers and contact washers, three-stage sealing by plastic axial plain washer on both sides

Technical information

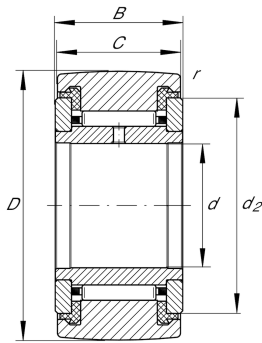

Your current product variant

Sealing	PP	Three-stage sealing by plastic axial plain washer on both sides
Outer ring profile	IOP	Optimized INA-profile
Relubrication facility	IR	Via inner ring

Main Dimensions & Performance Data

d	15 mm	Bore diameter
D	35 mm	Outside diameter
B	19 mm	Width of the bearing
C_{rW}	9.700 N	Basic dynamic load rating, radial
C_{0rW}	14.500 N	Basic static load rating, radial
C_{urW}	1.860 N	Fatigue load limit, radial
n_{DG}	3.600 1/min	Speed on permanent grease lubrication
F_{0rper}	14.500 N	Permissible static load, radial
F_{rper}	14.500 N	Permissible dynamic load outer ring, radial
$\approx m$	0,095 kg	Weight

Dimensions

C	18 mm	Width, outer ring
d_2	27,6 mm	Outside diameter of thrust washer
r_{min}	0,6 mm	Minimum chamfer dimension



Characteristics



Radial load



Lifetime lubrication, freedom from maintenance



Grease Lubrication



Sealed on both sides