**PWTR50-2RS-XL**

Yoke type track roller

Yoke type track rollers PWTR..-2RS-XL, double row cylindrical roller bearings with particularly thick-walled outer ring, with a central rib, full complement cylindrical roller set and an inner ring, the outer ring is guided axially by the central rib and rolling elements, protected lip seal on both sides, X-life design

X-life

Technical information

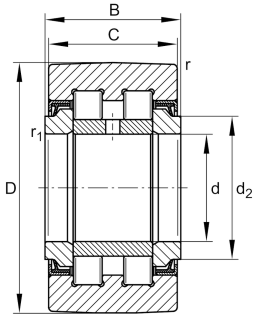

Your current product variant

Sealing	2RS	Protected lip seal on both sides
Outer ring profile	IOP	Optimized INA-profile
Relubrication facility	IR	Via inner ring

Main Dimensions & Performance Data

d	50 mm	Bore diameter
D	90 mm	Outside diameter
B	32 mm	Width of the bearing
C_{rw}	46.500 N	Basic dynamic load rating, radial
C_{0rw}	64.000 N	Basic static load rating, radial
C_{urw}	8.700 N	Fatigue load limit, radial
n_{DG}	1.100 1/min	Speed on permanent grease lubrication
F_{0rper}	64.000 N	Permissible static load, radial
F_{rper}	41.500 N	Permissible dynamic load outer ring, radial
$\approx m$	945,2 g	Weight



Dimensions

C	30 mm	Width, outer ring
d ₂	59,8 mm	Stop diameter of thrust washer
r _{min}	1,1 mm	Minimum chamfer dimension
r _{1 min}	0,6 mm	Minimum chamfer dimension

Characteristics



Radial load



Axial load in one direction



Axial load in two directions



Lifetime lubrication, freedom from maintenance



Grease Lubrication



Sealed on both sides