**NATV12**

Yoke type track roller

Yoke type track rollers NATV..., single row needle roller bearings with particularly thick-walled outer ring, full complement needle roller set and an inner ring, axial guidance of outer ring is provided by the contact washers, gap seals on both sides

Technical information

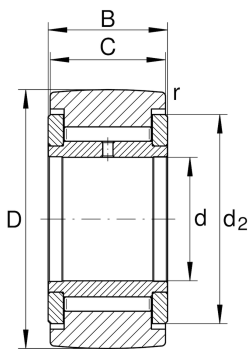

Your current product variant

| | | |
|--------------------|------|------------------------|
| Sealing | SPSP | Gap seal on both sides |
| Outer ring profile | R500 | R500 |

Main Dimensions & Performance Data

| | | |
|-------------|-------------|---|
| d | 12 mm | Bore diameter |
| D | 32 mm | Outside diameter |
| B | 15 mm | Width of the bearing |
| C_{rw} | 9.600 N | Basic dynamic load rating, radial |
| C_{0rw} | 15.900 N | Basic static load rating, radial |
| C_{urw} | 2.210 N | Fatigue load limit, radial |
| n_{DG} | 1.800 1/min | Speed on permanent grease lubrication |
| F_{0rper} | 15.900 N | Permissible static load, radial |
| F_{rper} | 14.900 N | Permissible dynamic load outer ring, radial |
| $\approx m$ | 72,997 g | Weight |

Dimensions

| | | |
|-----------|--------|--------------------------------------|
| C | 14 mm | Width, outer ring |
| d_2 | 25 mm | Outside diameter of thrust washer |
| r_{min} | 0,6 mm | Minimum chamfer dimension |
| R | 500 mm | Radius of outer ring outside profile |



Characteristics



Radial load



Grease Lubrication



Oil Lubrication



Not sealed