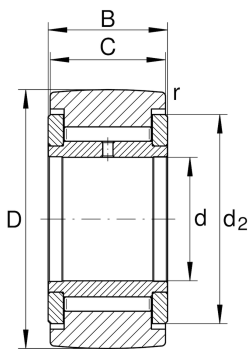
**NATV15** **Yoke type track roller**

Yoke type track rollers NATV..., single row needle roller bearings with particularly thick-walled outer ring, full complement needle roller set and an inner ring, axial guidance of outer ring is provided by the contact washers, gap seals on both sides

**Technical information****Your current product variant**

Type of Sealing	SPSP	Gap seal on both sides
Outer ring profile	R500	R500

**Main Dimensions & Performance Data**

d	15 mm	Bore diameter
D	35 mm	Outside diameter
B	19 mm	Width of the bearing
$C_{r w}$	12.700 N	Basic dynamic load rating, radial
$C_{0r w}$	23.400 N	Basic static load rating, radial
$C_{ur w}$	3.250 N	Fatigue load limit, radial
$n_{D G}$	1.600 1/min	Speed on permanent grease lubrication
$F_{0r per}$	23.400 N	Permissible static load, radial
$F_{r per}$	21.500 N	Permissible dynamic load outer ring, radial
$\approx m$	0,105 kg	Weight

**Dimensions**

C	18 mm	Width, outer ring
$d_2$	27,6 mm	Outside diameter of thrust washer
$r_{min}$	0,6 mm	Minimum chamfer dimension
R	500 mm	Radius of outer ring outside profile



### Characteristics

---



Radial load



Grease Lubrication



Oil Lubrication



Not sealed