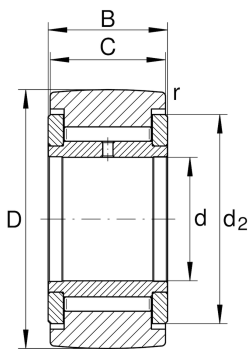
**NATV17** **Yoke type track roller**

Yoke type track rollers NATV..., single row needle roller bearings with particularly thick-walled outer ring, full complement needle roller set and an inner ring, axial guidance of outer ring is provided by the contact washers, gap seals on both sides

Technical information**Your current product variant**

Sealing	SPSP	Gap seal on both sides
Outer ring profile	R500	R500

Main Dimensions & Performance Data

d	17 mm	Bore diameter
D	40 mm	Outside diameter
B	21 mm	Width of the bearing
$C_{r w}$	14.700 N	Basic dynamic load rating, radial
$C_{0 r w}$	27.000 N	Basic static load rating, radial
$C_{u r w}$	3.550 N	Fatigue load limit, radial
$n_{D G}$	1.400 1/min	Speed on permanent grease lubrication
$F_{0 r per}$	27.000 N	Permissible static load, radial
$F_{r per}$	24.900 N	Permissible dynamic load outer ring, radial
m	0,153 kg	Weight

Dimensions

C	20 mm	Width, outer ring
d_2	31,5 mm	Outside diameter of thrust washer
r_{min}	1 mm	Minimum chamfer dimension
R	500 mm	Radius of outer ring outside profile



Characteristics



Radial load



Grease Lubrication



Oil Lubrication



Not sealed