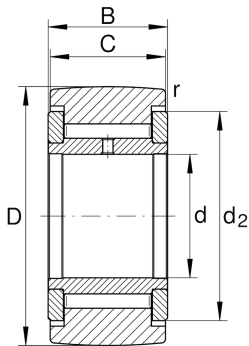
**NATV6**

Yoke type track roller

Yoke type track rollers NATV..., single row needle roller bearings with particularly thick-walled outer ring, full complement needle roller set and an inner ring, axial guidance of outer ring is provided by the contact washers, gap seals on both sides

Technical information

**Your current product variant**

Type of Seal	SPSP	Gap seal on both sides
Outer ring profile	R500	R500

Main Dimensions & Performance Data

d	6 mm	Bore diameter
D	19 mm	Outside diameter
B	12 mm	Width of the bearing
C_{rw}	5.400 N	Basic dynamic load rating, radial
C_{0rw}	8.100 N	Basic static load rating, radial
C_{urw}	1.190 N	Fatigue load limit, radial
n_{DG}	3.100 1/min	Speed on permanent grease lubrication
F_{0rper}	8.100 N	Permissible static load, radial
F_{rper}	7.100 N	Permissible dynamic load outer ring, radial
$\approx m$	0,021 kg	Weight

Dimensions

C	11 mm	Width, outer ring
d_2	15 mm	Outside diameter of thrust washer
r_{min}	0,15 mm	Minimum chamfer dimension
R	500 mm	Radius of outer ring outside profile



Characteristics



Radial load



Grease Lubrication



Oil Lubrication



Not sealed