**NATV8**

## Yoke type track roller

Yoke type track rollers NATV..., single row needle roller bearings with particularly thick-walled outer ring, full complement needle roller set and an inner ring, axial guidance of outer ring is provided by the contact washers, gap seals on both sides

## Technical information

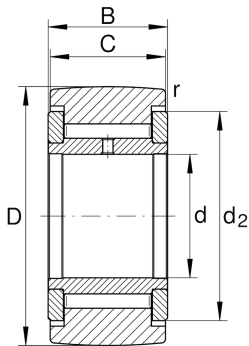

## Your current product variant

Sealing	SPSP	Gap seal on both sides
Outer ring profile	R500	R500

## Main Dimensions &amp; Performance Data

d	8 mm	Bore diameter
D	24 mm	Outside diameter
B	15 mm	Width of the bearing
$C_{r w}$	7.800 N	Basic dynamic load rating, radial
$C_{0 r w}$	11.700 N	Basic static load rating, radial
$C_{u r w}$	1.620 N	Fatigue load limit, radial
$n_{D G}$	2.500 1/min	Speed on permanent grease lubrication
$F_{0 r per}$	11.700 N	Permissible static load, radial
$F_{r per}$	10.200 N	Permissible dynamic load outer ring, radial
$\approx m$	41,9 g	Weight

## Dimensions

C	14 mm	Width, outer ring
$d_2$	19 mm	Outside diameter of thrust washer
$r_{min}$	0,3 mm	Minimum chamfer dimension
R	500 mm	Radius of outer ring outside profile



### Characteristics

---



Radial load



Grease Lubrication



Oil Lubrication



Not sealed