**NNTR140X340X162-2ZL**

## Yoke type track roller

Yoke type track roller NNTR..-2ZL, CRB, full complement roller set, two-row, with inner ring, 3 ribs on outer ring, not pallet changer

## Technical information

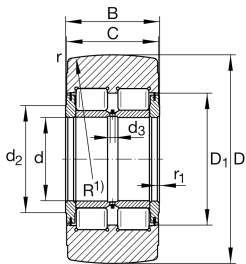

## Your current product variant

Sealing	2ZL	Sealing shields on both sides
---------	-----	-------------------------------

## Main Dimensions &amp; Performance Data

d	140 mm	Bore diameter
D	340 mm	Outside diameter
B	162 mm	Width, inner ring
$C_{rW}$	1.200.000 N	Basic dynamic load rating, radial
$C_{0rW}$	1.970.000 N	Basic static load rating, radial
$C_{urW}$	265.000 N	Fatigue load limit, radial
$n_{DG}$	220 1/min	Speed on permanent grease lubrication
$F_{0rper}$	1.970.000 N	Permissible static load, radial
$F_{rper}$	1.450.000 N	Permissible dynamic load outer ring, radial
$\approx m$	87,3 kg	Weight

## Mounting dimensions







$d_2$	186 mm	Stop diameter of thrust washer
$D_1$	228 mm	Mounting dimension
$d_3$	8 mm	Diameter lubrication hole
R	15.000 mm	Radius of outer ring outside profile
	6	Number of lubrication holes



### Dimensions

C	160 mm	Width, outer ring
r <sub>min</sub>	4 mm	Minimum chamfer dimension
r <sub>1 min</sub>	4 mm	Minimum chamfer dimension

### Characteristics

-  Radial load
-  Axial load in one direction
-  Axial load in two directions
-  Lifetime lubrication, freedom from maintenance
-  Grease Lubrication
-  Sealed on both sides