

**NNTR55X140X70-2ZL**

Yoke type track roller

Yoke type track roller NNTR..-2ZL, CRB, full complement roller set, two-row, with inner ring, 3 ribs on outer ring, not pallet changer

Technical information

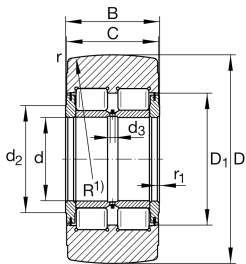

Your current product variant

Sealing	2ZL	Sealing shields on both sides
---------	-----	-------------------------------

Main Dimensions & Performance Data

d	55 mm	Bore diameter
D	140 mm	Outside diameter
B	70 mm	Width, inner ring
$C_{r w}$	219.000 N	Basic dynamic load rating, radial
$C_{0r w}$	320.000 N	Basic static load rating, radial
$C_{ur w}$	48.000 N	Fatigue load limit, radial
$n_{D G}$	850 1/min	Speed on permanent grease lubrication
$F_{0r per}$	320.000 N	Permissible static load, radial
$F_{r per}$	280.000 N	Permissible dynamic load outer ring, radial
$\approx m$	6,29 kg	Weight

Mounting dimensions







d_2	73 mm	Stop diameter of thrust washer
D_1	91 mm	Mounting dimension
d_3	4 mm	Diameter lubrication hole
R	10.000 mm	Radius of outer ring outside profile
	3	Number of lubrication holes



Dimensions

C	68 mm	Width, outer ring
r _{min}	3 mm	Minimum chamfer dimension
r _{1 min}	2 mm	Minimum chamfer dimension

Characteristics

-  Radial load
-  Axial load in one direction
-  Axial load in two directions
-  Lifetime lubrication, freedom from maintenance
-  Grease Lubrication
-  Sealed on both sides