

**NNTR60X150X75-2ZL**

## Yoke type track roller

Yoke type track roller NNTR..-2ZL, CRB, full complement roller set, two-row, with inner ring, 3 ribs on outer ring, not pallet changer

## Technical information

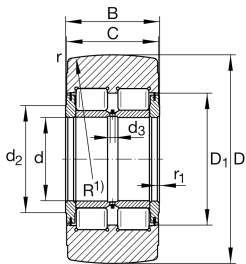

## Your current product variant

Type of Sealing	2ZL	Sealing shields on both sides
-----------------	-----	-------------------------------

## Main Dimensions &amp; Performance Data

d	60 mm	Bore diameter
D	150 mm	Outside diameter
B	75 mm	Width, inner ring
$C_{r w}$	250.000 N	Basic dynamic load rating, radial
$C_{0 r w}$	370.000 N	Basic static load rating, radial
$C_{u r w}$	57.000 N	Fatigue load limit, radial
$n_{D G}$	800 1/min	Speed on permanent grease lubrication
$F_{0 r per}$	370.000 N	Permissible static load, radial
$F_{r per}$	330.000 N	Permissible dynamic load outer ring, radial
$\approx m$	7,704 kg	Weight

## Mounting dimensions





$d_2$	78 mm	Stop diameter of thrust washer
$D_1$	97 mm	Mounting dimension
$d_3$	4 mm	Diameter lubrication hole
R	10.000 mm	Radius of outer ring outside profile
	3	Number of lubrication holes

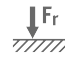
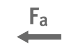

### Dimensions

C	73 mm	Width, outer ring
r <sub>min</sub>	3 mm	Minimum chamfer dimension
r <sub>1 min</sub>	2 mm	Minimum chamfer dimension

### Characteristics

-  Radial load
-  Axial load in one direction
-  Axial load in two directions
-  Lifetime lubrication, freedom from maintenance
-  Grease Lubrication
-  Sealed on both sides