

**NNTR90X220X100-2ZL** [↗](#)

Yoke type track roller

Yoke type track roller NNTR..-2ZL, CRB, full complement roller set, two-row, with inner ring, 3 ribs on outer ring, not pallet changer

Technical information

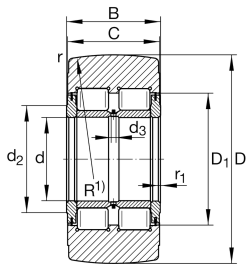

Your current product variant

Sealing	2ZL	Sealing shields on both sides
---------	-----	-------------------------------

Main Dimensions & Performance Data

d	90 mm	Bore diameter
D	220 mm	Outside diameter
B	100 mm	Width, inner ring
C_{rW}	490.000 N	Basic dynamic load rating, radial
C_{0rW}	760.000 N	Basic static load rating, radial
C_{urW}	112.000 N	Fatigue load limit, radial
n_{DG}	400 1/min	Speed on permanent grease lubrication
F_{0rper}	760.000 N	Permissible static load, radial
F_{rper}	600.000 N	Permissible dynamic load outer ring, radial
$\approx m$	22,055 kg	Weight

Mounting dimensions







d_2	119 mm	Stop diameter of thrust washer
D_1	146 mm	Mounting dimension
d_3	5 mm	Diameter lubrication hole
R	10.000 mm	Radius of outer ring outside profile
	3	Number of lubrication holes



Dimensions

C	98 mm	Width, outer ring
r _{min}	4 mm	Minimum chamfer dimension
r _{1 min}	2,5 mm	Minimum chamfer dimension

Characteristics

-  Radial load
-  Axial load in one direction
-  Axial load in two directions
-  Lifetime lubrication, freedom from maintenance
-  Grease Lubrication
-  Sealed on both sides