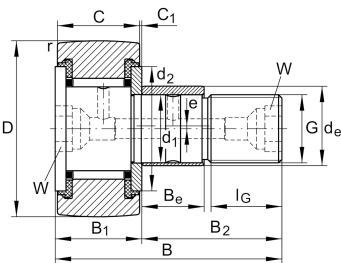
**KRE22-PP** **Stud type track roller**

Stud type track rollers KRE...-PP-A, single row needle roller bearings with particularly thick-walled outer ring, needle roller and cage assembly and a solid roller stud with fixing thread and a mounting aid, axial guidance of outer ring is provided by the plastic axial plain washers, contact flange and contact washer, three-stage sealing by plastic axial plain washer on both sides, with eccentric collar

Technical information

**Your current product variant**

Type of Sealing	PP	Three-stage sealing by plastic axial plain washer on both sides
Outer ring profile	IOP	Optimized INA-profile
Grease nipples	2x	Drive-fit lubrication nipple unmounted 2x
Assembling aid head	I6	Hexagon socket
Mounting aid	I6	Hexagon socket

Main Dimensions & Performance Data

D	22 mm	Outside diameter
d ₁	10 mm	Fit diameter of roller stud / stud
B	36 mm	Width
C _{r w}	4.500 N	Basic dynamic load rating, radial
C _{0r w}	5.400 N	Basic static load rating, radial
C _{ur w}	740 N	Fatigue load limit, radial
n _{D G}	8.000 1/min	Speed on permanent grease lubrication
≈m	44,919 g	Weight







Dimensions

B ₁	13,2 mm	Width of thrust washer
B ₂	23 mm	Bolt/stud length effectively
C	12 mm	Width, outer ring
C ₁	0,6 mm	Protrusion outer ring to thrust washer
r _{min}	0,3 mm	Minimum chamfer dimension
d ₂	17,5 mm	Stop diameter of thrust washer
G	M10X1	Thread
l _G	12 mm	Thread length
W	5 mm	Nominal dimension for hexagonal socket
d _e	13 mm	Diameter of eccentric
B _e	10 mm	Width, eccentric
e	0,5 mm	Eccentricity

Additional information

	NIPA1X4,5	Drive-fit lubrication nipple
M _A	15 Nm	Tightening torque nut

Characteristics

-  Radial load
-  Lifetime lubrication, freedom from maintenance
-  Grease Lubrication
-  Sealed on both sides