**KRE35-PP**

## Stud type track roller

Stud type track rollers KRE...-PP-A, single row needle roller bearings with particularly thick-walled outer ring, needle roller and cage assembly and a solid roller stud with fixing thread and a mounting aid, axial guidance of outer ring is provided by the plastic axial plain washers, contact flange and contact washer, three-stage sealing by plastic axial plain washer on both sides, with eccentric collar

## Technical information

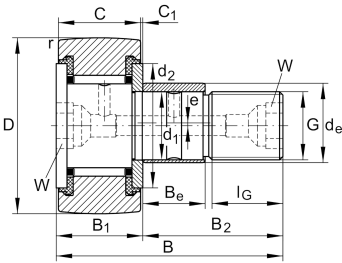

## Your current product variant

Type of Seal	PP	Three-stage sealing by plastic axial plain washer on both sides
Outer ring profile	IOP	Optimized INA-profile
Grease nipples	2x	Drive-fit lubrication nipple unmounted 2x
Assembling aid head	I6	Hexagon socket
Mounting aid	I6	Hexagon socket

## Main Dimensions &amp; Performance Data

D	35 mm	Outside diameter
d <sub>1</sub>	16 mm	Fit diameter of roller stud / stud
B	52 mm	Width
C <sub>r w</sub>	9.700 N	Basic dynamic load rating, radial
C <sub>0r w</sub>	14.500 N	Basic static load rating, radial
C <sub>ur w</sub>	1.860 N	Fatigue load limit, radial
n <sub>D G</sub>	3.600 1/min	Speed on permanent grease lubrication
≈m	0,177 kg	Weight







## Dimensions

B <sub>1</sub>	19,6 mm	Width of thrust washer
B <sub>2</sub>	32,5 mm	Bolt/stud length effectively
B <sub>3</sub>	8 mm	Distance to lubrication hole
C	18 mm	Width, outer ring
C <sub>1</sub>	0,8 mm	Protrusion outer ring to thrust washer
r <sub>min</sub>	0,6 mm	Minimum chamfer dimension
d <sub>2</sub>	27,6 mm	Stop diameter of thrust washer
d <sub>3</sub>	3 mm	Diameter lubrication hole
G	M16X1,5	Thread
l <sub>G</sub>	17 mm	Thread length
W	8 mm	Nominal dimension for hexagonal socket
d <sub>e</sub>	20 mm	Diameter of eccentric
B <sub>e</sub>	14 mm	Width, eccentric
e	1 mm	Eccentricity

## Additional information

	NIPA2X7,5	Drive-fit lubrication nipple
M <sub>A</sub>	58 Nm	Tightening torque nut

## Characteristics

-  Radial load
-  Lifetime lubrication, freedom from maintenance
-  Grease Lubrication
-  Sealed on both sides