**KRE90-PP**

Stud type track roller

Stud type track rollers KRE...-PP-A, single row needle roller bearings with particularly thick-walled outer ring, needle roller and cage assembly and a solid roller stud with fixing thread and a mounting aid, axial guidance of outer ring is provided by the plastic axial plain washers, contact flange and contact washer, three-stage sealing by plastic axial plain washer on both sides, with eccentric collar

Technical information

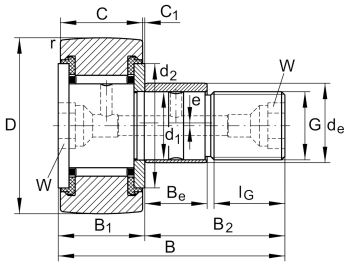

Your current product variant

Type of Seal	PP	Three-stage sealing by plastic axial plain washer on both sides
Outer ring profile	IOP	Optimized INA-profile
Grease nipples	2x	Drive-fit lubrication nipple unmounted 2x
Assembling aid head	I6	Hexagon socket
Mounting aid	I6	Hexagon socket

Main Dimensions & Performance Data

D	90 mm	Outside diameter
d ₁	30 mm	Fit diameter of roller stud / stud
B	100 mm	Width
C _{r w}	40.500 N	Basic dynamic load rating, radial
C _{0r w}	84.000 N	Basic static load rating, radial
C _{ur w}	11.900 N	Fatigue load limit, radial
n _{D G}	1.300 1/min	Speed on permanent grease lubrication
≈m	1,942 kg	Weight







Dimensions

B ₁	37 mm	Width of thrust washer
B ₂	63 mm	Bolt/stud length effectively
B ₃	15 mm	Distance to lubrication hole
C	35 mm	Width, outer ring
C ₁	1 mm	Protrusion outer ring to thrust washer
r _{min}	1,1 mm	Minimum chamfer dimension
d ₂	53 mm	Stop diameter of thrust washer
d ₃	4 mm	Diameter lubrication hole
G	M30X1,5	Thread
l _G	32 mm	Thread length
W	14 mm	Nominal dimension for hexagonal socket
d _e	35 mm	Diameter of eccentric
B _e	29 mm	Width, eccentric
e	1,5 mm	Eccentricity

Additional information

	NIPA3X9,5	Drive-fit lubrication nipple
M _A	450 Nm	Tightening torque nut

Characteristics

-  Radial load
-  Lifetime lubrication, freedom from maintenance
-  Grease Lubrication
-  Sealed on both sides