**ZL203-DRS** [↗](#)

## Stud type track roller

Stud type track rollers ZL2...-DRS, single row self-retaining ball bearings with particularly thick-walled outer ring, ball and cage assembly, without eccentric collar and with a solid, short roller stud with threaded hole, axial guidance of outer ring is provided by the balls, lip seal on stud side axial sealing action, sealing shield with cover on the end face, mounting aid on the face side: mounting slot, no relubrication facility

## Technical information

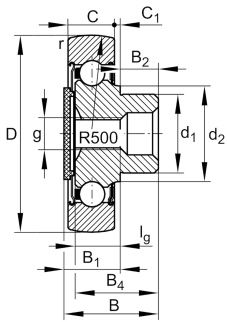

## Your current product variant

Sealing	DRS	Lip seal on stud side, axial sealing action Sealing shield with cover on the end face
Outer ring profile	R500	R500
Relubrication facility	Without	Without
Assembling aid head	SL	Mounting slot

## Main Dimensions &amp; Performance Data





D	47 mm	Outside diameter
d <sub>1</sub>	18 mm	Fit diameter of roller stud / stud
B	26,5 mm	Width
C <sub>r w</sub>	8.900 N	Basic dynamic load rating, radial
C <sub>0 r w</sub>	4.550 N	Basic static load rating, radial
C <sub>u r w</sub>	229 N	Fatigue load limit, radial
n <sub>D G</sub>	6.500 1/min	Speed on permanent grease lubrication
≈m	0,12 kg	Weight

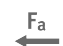

## Dimensions

B 1 max	14,5 mm	Maximum width of thrust washer
B 2	12 mm	Bolt/stud length effectively
B 4	24,5 mm	Length total
C	12 mm	Width, outer ring
C 1	2 mm	Protrusion outer ring to thrust washer
d 2	22,9 mm	Stop diameter of thrust washer
r min	0,6 mm	Minimum chamfer dimension
g	M8	Thread inside
l g	16 mm	Thread length (inner)
R	500 mm	Radius of outer ring outside profile

## Characteristics

-  Radial load
-  Axial load in one direction
-  Axial load in two directions
-  Lifetime lubrication, freedom from maintenance
-  Grease Lubrication
-  Sealed on both sides