**ZL205-DRS** [↗](#)

Stud type track roller

Stud type track rollers ZL2...-DRS, single row self-retaining ball bearings with particularly thick-walled outer ring, ball and cage assembly, without eccentric collar and with a solid, short roller stud with threaded hole, axial guidance of outer ring is provided by the balls, lip seal on stud side axial sealing action, sealing shield with cover on the end face, mounting aid on the face side: mounting slot, no relubrication facility

Technical information

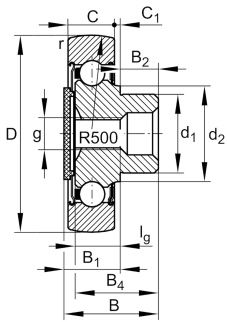

Your current product variant

| | | |
|---------------------|---------|--|
| Sealing | DRS | Lip seal on stud side, axial sealing action Sealing shield with cover on the end face |
| Outer ring profile | R500 | R500 |
| Relubrication | Without | Without |
| Assembling aid head | SL | Mounting slot |

Main Dimensions & Performance Data





| | | |
|--------------------|-------------|---------------------------------------|
| D | 62 mm | Outside diameter |
| d ₁ | 25 mm | Fit diameter of roller stud / stud |
| B | 33,8 mm | Width |
| C _{r w} | 13.200 N | Basic dynamic load rating, radial |
| C _{0 r w} | 7.200 N | Basic static load rating, radial |
| C _{u r w} | 365 N | Fatigue load limit, radial |
| n _{D G} | 5.500 1/min | Speed on permanent grease lubrication |
| ≈m | 0,25 kg | Weight |

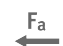

Dimensions

| | | |
|---------|---------|--|
| B 1 max | 18 mm | Maximum width of thrust washer |
| B 2 | 16 mm | Bolt/stud length effectively |
| B 4 | 31 mm | Length total |
| C | 15 mm | Width, outer ring |
| C 1 | 2 mm | Protrusion outer ring to thrust washer |
| d 2 | 30,3 mm | Stop diameter of thrust washer |
| r min | 1 mm | Minimum chamfer dimension |
| g | M10 | Thread inside |
| l g | 19 mm | Thread length (inner) |
| R | 500 mm | Radius of outer ring outside profile |

Characteristics

-  Radial load
-  Axial load in one direction
-  Axial load in two directions
-  Lifetime lubrication, freedom from maintenance
-  Grease Lubrication
-  Sealed on both sides