

**PCJT20-XL-N**

Flanged housing unit

Housing units PCJT, two-bolt flanged housing units, cast iron, eccentric locking collar, P seals

X-life

Technical information

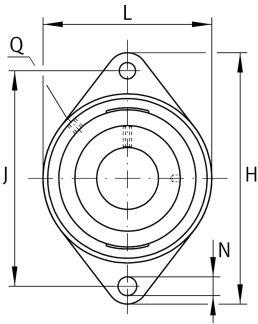

Your current product variant

Groove	N	Cast iron housing with undercut slot for end caps
Material	GG	Grey cast iron

Main Dimensions & Performance Data

d	20 mm	Bore diameter
L	61 mm	Flange width
H	112 mm	Height flange
U	42,5 mm	Total height unit
C _r	13.600 N	Basic dynamic load rating, radial
C _{0r}	6.600 N	Basic static load rating, radial
C _{ur}	345 N	Fatigue load limit, radial
≈m	0,44 kg	Weight

Mounting dimensions

J	90 mm	Distance fixing bore
N	11,5 mm	Fixing bore
n	2	Number of screwing holes



Dimensions

A	28 mm	Height housing
A ₁	10 mm	Thickness of flange
A ₂	19 mm	Distance raceway
V	61 mm	Shoulder diameter housing
Q	M6	Connection thread for lubrication
d ₃	33 mm	Outside diameter locking collar

Additional information

1	Number of housings
CJT04	Housing
GRAE20-XL-NPP-B	Bearing designation
KASK04	Protecting cap

Temperature range

T _{min}	-20 °C	Operating temperature min.
T _{max}	120 °C	Operating temperature max.