

**RCJT70-XL**

Flanged housing unit

Housing units RCJT, two-bolt flanged housing units, cast iron, eccentric locking collar, R seals

X-life

Technical information

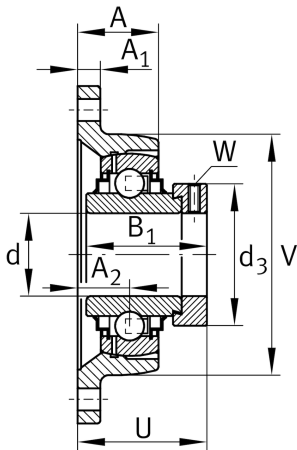
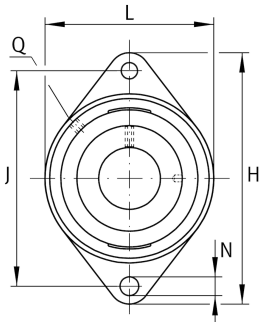

Your current product variant

Material	GG	Grey cast iron
----------	----	----------------

Main Dimensions & Performance Data

d	70 mm	Bore diameter
L	160 mm	Flange width
H	258 mm	Height flange
U	82,6 mm	Total height unit
C _r	62.000 N	Basic dynamic load rating, radial
C _{0r}	44.000 N	Basic static load rating, radial
C _{ur}	2.300 N	Fatigue load limit, radial
≈m	5,33 kg	Weight

Mounting dimensions

J	216 mm	Distance fixing bore
N	21 mm	Fixing bore
n	2	Number of screwing holes
W	6 mm	Width of flats



Dimensions

A	57 mm	Height housing
A ₁	18 mm	Thickness of flange
A ₂	38 mm	Distance raceway
B ₁	66 mm	Locking collar total width
V	160 mm	Shoulder diameter housing
Q	M6	Connection thread for lubrication
d ₃	96 mm	Outside diameter locking collar

Additional information

1	Number of housings
CJT13/14	Housing
GE70-XL-KRR-B	Bearing designation

Temperature range

T _{min}	-20 °C	Operating temperature min.
T _{max}	120 °C	Operating temperature max.