

**RCJT25-XL-N**

## Flanged housing unit

Housing units RCJT, two-bolt flanged housing units, cast iron, eccentric locking collar, R seals

X-life

## Technical information

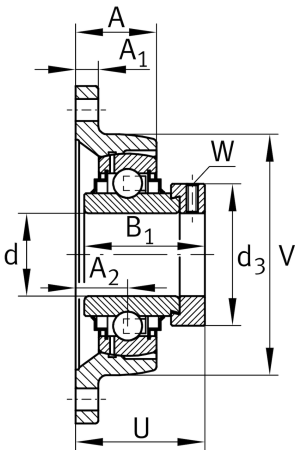

## Your current product variant

Groove	N	Cast iron housing with undercut slot for end caps
Material	GG	Grey cast iron

## Main Dimensions &amp; Performance Data

d	25 mm	Bore diameter
L	70 mm	Flange width
H	124 mm	Height flange
U	46 mm	Total height unit
$C_r$	14.000 N	Basic dynamic load rating, radial
$C_{0r}$	7.800 N	Basic static load rating, radial
$C_{ur}$	370 N	Fatigue load limit, radial
$\approx m$	0,63 kg	Weight

## Mounting dimensions

J	99 mm	Distance fixing bore
N	11,5 mm	Fixing bore
n	2	Number of screwing holes
W	3 mm	Width of flats



### Dimensions

A	28,5 mm	Height housing
A <sub>1</sub>	11 mm	Thickness of flange
A <sub>2</sub>	19 mm	Distance raceway
B <sub>1</sub>	44,5 mm	Locking collar total width
V	70 mm	Shoulder diameter housing
Q	M6	Connection thread for lubrication
d <sub>3</sub>	37,5 mm	Outside diameter locking collar

### Additional information

GEHCJT05-GG-N	Housing
GE25-XL-KRR-B	Bearing designation
KASK05	Protecting cap

### Temperature range

T <sub>min</sub>	-20 °C	Operating temperature min.
T <sub>max</sub>	100 °C	Operating temperature max.