

**RCJTA25-XL-N**

Flanged housing unit

Housing units RCJTA, two-bolt flanged housing units, cast iron, adapter sleeve, R seals

X-life

Technical information

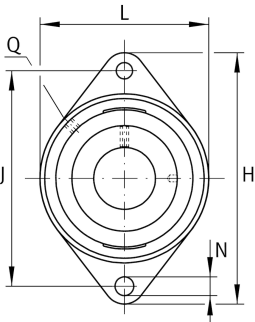

Your current product variant

Groove	N	Cast iron housing with undercut slot for end caps
Material	GG	Grey cast iron

Main Dimensions & Performance Data

d	25 mm	Bore diameter
L	70 mm	Flange width
H	124 mm	Height flange
U	40,4 mm	Total height unit
C _r	14.400 N	Basic dynamic load rating, radial
C _{0r}	8.100 N	Basic static load rating, radial
C _{ur}	420 N	Fatigue load limit, radial
≈m	0,55 kg	Weight

Mounting dimensions

J	99 mm	Distance fixing bore
N	11,5 mm	Fixing bore
n	2	Number of screwing holes

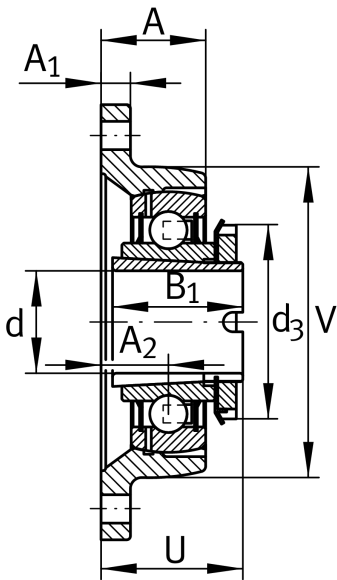



Dimensions

A	28,5 mm	Height housing
A ₁	11 mm	Thickness of flange
A ₂	19 mm	Distance raceway
B ₁	28 mm	Locking collar total width
V	70 mm	Shoulder diameter housing
Q	M6	Connection thread for lubrication
d ₃	38 mm	Outside diameter locking collar

Additional information

GEHCJT05-GG-N	Housing
GSH25-XL-2RSR-B	Bearing designation
KASK05	Protecting cap

Temperature range

T _{min}	-20 °C	Operating temperature min.
T _{max}	100 °C	Operating temperature max.