

**RCJTA30-XL-N**

Flanged housing unit

Housing units RCJTA, two-bolt flanged housing units, cast iron, adapter sleeve, R seals

X-life

Technical information

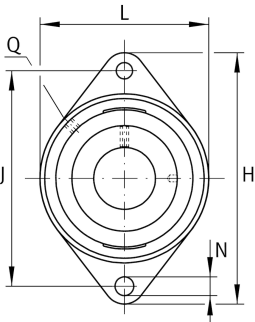

Your current product variant

Groove	N	Cast iron housing with undercut slot for end caps
Material	GG	Grey cast iron

Main Dimensions & Performance Data

d	30 mm	Bore diameter
L	80 mm	Flange width
H	142 mm	Height flange
U	44 mm	Total height unit
C_r	20.100 N	Basic dynamic load rating, radial
C_{0r}	11.600 N	Basic static load rating, radial
C_{ur}	600 N	Fatigue load limit, radial
$\approx m$	0,8 kg	Weight

Mounting dimensions

J	116,5 mm	Distance fixing bore
N	11,5 mm	Fixing bore
n	2	Number of screwing holes

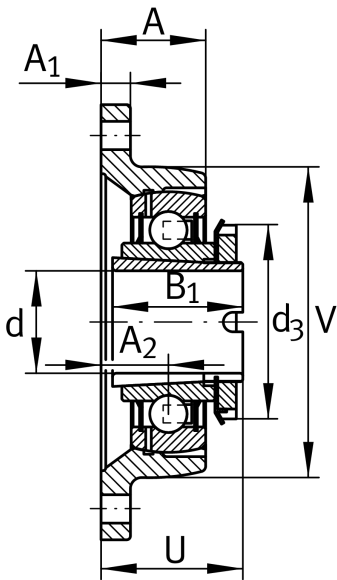



Dimensions

A	31 mm	Height housing
A ₁	12 mm	Thickness of flange
A ₂	20 mm	Distance raceway
B ₁	32 mm	Locking collar total width
V	80 mm	Shoulder diameter housing
Q	M6	Connection thread for lubrication
d ₃	45 mm	Outside diameter locking collar

Additional information

GEHCJT06-GG-N	Housing
GSH30-XL-2RSR-B	Bearing designation
KASK06	Protecting cap

Temperature range

T _{min}	-20 °C	Operating temperature min.
T _{max}	100 °C	Operating temperature max.