

**RCJTA35-XL-N**

Flanged housing unit

Housing units RCJTA, two-bolt flanged housing units, cast iron, adapter sleeve, R seals

X-life

Technical information

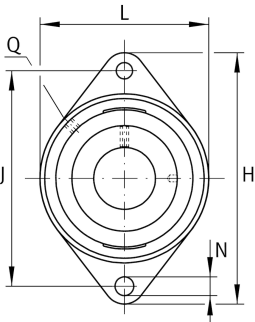

Your current product variant

| | | |
|----------|----|---|
| Groove | N | Cast iron housing with undercut slot for end caps |
| Material | GG | Grey cast iron |

Main Dimensions & Performance Data

| | | |
|-----------------|----------|-----------------------------------|
| d | 35 mm | Bore diameter |
| L | 92 mm | Flange width |
| H | 155 mm | Height flange |
| U | 46 mm | Total height unit |
| C _r | 24.900 N | Basic dynamic load rating, radial |
| C _{0r} | 15.300 N | Basic static load rating, radial |
| C _{ur} | 820 N | Fatigue load limit, radial |
| ≈m | 1,06 kg | Weight |

Mounting dimensions

| | | |
|---|--------|--------------------------|
| J | 130 mm | Distance fixing bore |
| N | 14 mm | Fixing bore |
| n | 2 | Number of screwing holes |

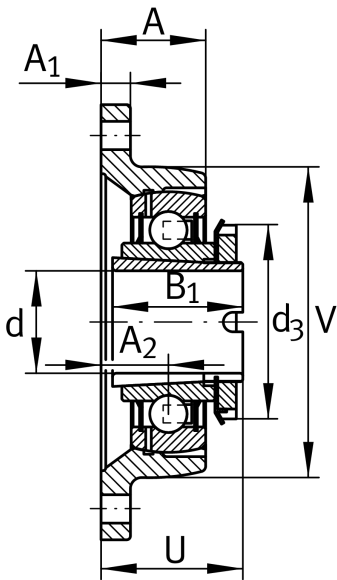



Dimensions

| | | |
|----------------|---------|-----------------------------------|
| A | 32,5 mm | Height housing |
| A ₁ | 12,5 mm | Thickness of flange |
| A ₂ | 21 mm | Distance raceway |
| B ₁ | 34 mm | Locking collar total width |
| V | 92 mm | Shoulder diameter housing |
| Q | M6 | Connection thread for lubrication |
| d ₃ | 52 mm | Outside diameter locking collar |

Additional information

| | |
|-----------------|---------------------|
| GEHCJT07-GG-N | Housing |
| GSH35-XL-2RSR-B | Bearing designation |
| KASK07 | Protecting cap |

Temperature range

| | | |
|------------------|--------|----------------------------|
| T _{min} | -20 °C | Operating temperature min. |
| T _{max} | 100 °C | Operating temperature max. |