

**RCJTA40-XL-N**

Flanged housing unit

Housing units RCJTA, two-bolt flanged housing units, cast iron, adapter sleeve, R seals

X-life

Technical information

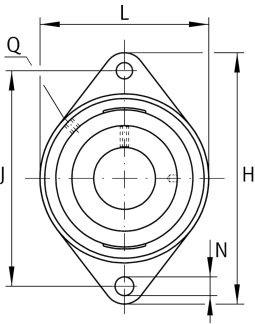

Your current product variant

| | | |
|----------|----|---|
| Groove | N | Cast iron housing with undercut slot for end caps |
| Material | GG | Grey cast iron |

Main Dimensions & Performance Data

| | | |
|-------------|----------|-----------------------------------|
| d | 40 mm | Bore diameter |
| L | 105 mm | Flange width |
| H | 172 mm | Height flange |
| U | 52,2 mm | Total height unit |
| C_r | 29.500 N | Basic dynamic load rating, radial |
| C_{0r} | 19.800 N | Basic static load rating, radial |
| C_{ur} | 930 N | Fatigue load limit, radial |
| $\approx m$ | 1,47 kg | Weight |

Mounting dimensions

| | | |
|---|----------|--------------------------|
| J | 143,5 mm | Distance fixing bore |
| N | 14 mm | Fixing bore |
| n | 2 | Number of screwing holes |

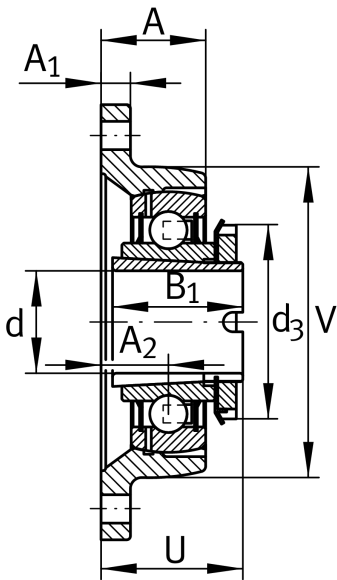



Dimensions

| | | |
|----------------|---------|-----------------------------------|
| A | 36,5 mm | Height housing |
| A ₁ | 13 mm | Thickness of flange |
| A ₂ | 24 mm | Distance raceway |
| B ₁ | 38 mm | Locking collar total width |
| V | 105 mm | Shoulder diameter housing |
| Q | M6 | Connection thread for lubrication |
| d ₃ | 58 mm | Outside diameter locking collar |

Additional information

| | |
|-----------------|---------------------|
| 1 | Number of housings |
| GEHCJT08-GG-N | Housing |
| GSH40-XL-2RSR-B | Bearing designation |
| KASK08 | Protecting cap |

Temperature range

| | | |
|------------------|--------|----------------------------|
| T _{min} | -20 °C | Operating temperature min. |
| T _{max} | 100 °C | Operating temperature max. |