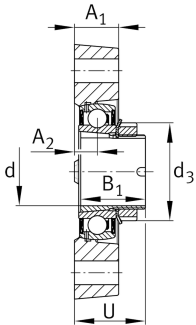
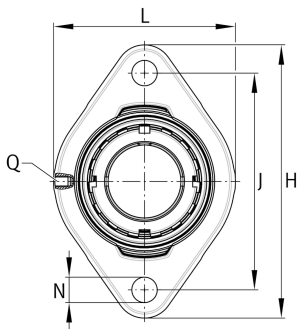

**RGLCTEA30-N**

Flanged housing unit

Flanged housing unit RGLCTEA...-N

Technical information

**Your current product variant**

Groove	N	Cast iron housing with undercut slot for end caps
Material	GG	Grey cast iron

Main Dimensions & Performance Data

d	30 mm	Bore diameter
L	84 mm	Flange width
H	112,5 mm	Height flange
U	36,7 mm	Total height unit
C _r	18.900 N	Basic dynamic load rating, radial
C _{0r}	11.300 N	Basic static load rating, radial
C _{ur}	600 N	Fatigue load limit, radial
≈m	0,7 kg	Weight

Mounting dimensions

J	90,5 mm	Distance fixing bore
N	11,5 mm	Fixing bore
n	2	Number of screwing holes



Dimensions

A ₁	22,5 mm	Thickness of flange
A ₂	12,75 mm	Distance raceway
B ₁	32 mm	Locking collar total width
Q	M6	Connection thread for lubrication

Additional information

GEHGLCTE06-GG-N	Housing
GSH30-XL-2RSR-B	Bearing designation

Temperature range

T _{min}	-20 °C	Operating temperature min.
T _{max}	100 °C	Operating temperature max.