

IMAGE  
COMING SOON**GLCTE20-TV-FA125.5**

Flanged housing unit

Flanged housing unit GLCTE...-TV

## Technical information

**Your current product variant**

Material	TV	Plastic
Manufacturing instruction	FA125.5	Bearing with Corrotect coating

**Main Dimensions & Performance Data**

d	20 mm	Bore diameter
L	66,5 mm	Flange width
H	90,5 mm	Height flange
U	33,5 mm	Total height unit
$C_r$	13.600 N	Basic dynamic load rating, radial
$C_{0r}$	6.600 N	Basic static load rating, radial
$C_{0rG}$	7.200 N	Load carrying capacity (housing)
$\approx m$	0,26 kg	Weight

**Mounting dimensions**

J	71,4 mm	Distance fixing bore
N	9 mm	Fixing bore
n	2	Number of screwing holes

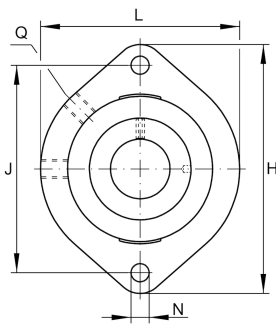



### Dimensions

A <sub>1</sub>	18,4 mm	Thickness of flange
A <sub>2</sub>	9,5 mm	Distance raceway
B <sub>1</sub>	31 mm	Locking collar total width
Q	1/4-28 UNF	Connection thread for lubrication
d <sub>3</sub>	33 mm	Outside diameter eccentric locking collar

### Additional information

1	Number of housings
GLCTE04-TV	Housing
GRAE20-NPP-B-FA107/125.5	Bearing designation
KASK04-S-G	Protecting cap

### Temperature range

T <sub>min</sub>	-35 °C	Operating temperature min.
T <sub>max</sub>	100 °C	Operating temperature max.