

IMAGE  
COMING SOON**GLCTE30-TV-FA125.5**

Flanged housing unit

Flanged housing unit GLCTE...-TV

## Technical information

**Your current product variant**

|                           |         |                                |
|---------------------------|---------|--------------------------------|
| Material                  | TV      | Plastic                        |
| Manufacturing instruction | FA125.5 | Bearing with Corrotect coating |

**Main Dimensions & Performance Data**

|             |          |                                   |
|-------------|----------|-----------------------------------|
| d           | 30 mm    | Bore diameter                     |
| L           | 84 mm    | Flange width                      |
| H           | 112,5 mm | Height flange                     |
| U           | 38,3 mm  | Total height unit                 |
| $C_r$       | 17.100 N | Basic dynamic load rating, radial |
| $C_{0r}$    | 9.200 N  | Basic static load rating, radial  |
| $C_{0rG}$   | 12.000 N | Load carrying capacity (housing)  |
| $\approx m$ | 0,47 kg  | Weight                            |

**Mounting dimensions**

|   |         |                          |
|---|---------|--------------------------|
| J | 90,5 mm | Distance fixing bore     |
| N | 11,5 mm | Fixing bore              |
| n | 2       | Number of screwing holes |

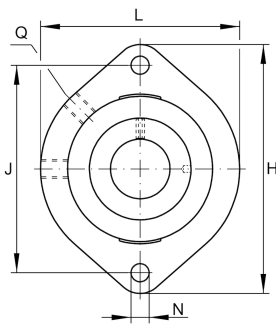



### Dimensions

|                |            |   |
|----------------|------------|---|
| A <sub>1</sub> | 20,5 mm    | Thickness of flange                       |
| A <sub>2</sub> | 11,5 mm    | Distance raceway                          |
| B <sub>1</sub> | 35,8 mm    | Locking collar total width                |
| Q              | 1/4-28 UNF | Connection thread for lubrication         |
| d <sub>3</sub> | 44 mm      | Outside diameter eccentric locking collar |

### Additional information

|                          |                     |
|--------------------------|---------------------|
| 1                        | Number of housings  |
| GLCTE06-TV               | Housing             |
| GRAE30-NPP-B-FA107/125.5 | Bearing designation |
| KASK06-S-G               | Protecting cap      |

### Temperature range

|                  |        |                            |
|------------------|--------|----------------------------|
| T <sub>min</sub> | -35 °C | Operating temperature min. |
| T <sub>max</sub> | 100 °C | Operating temperature max. |