

**RME20-XL-N**

## Flanged housing unit

Housing units RME, four-bolt flanged housing units, cast iron, centring spigot, eccentric locking collar, R seals

X-life

## Technical information

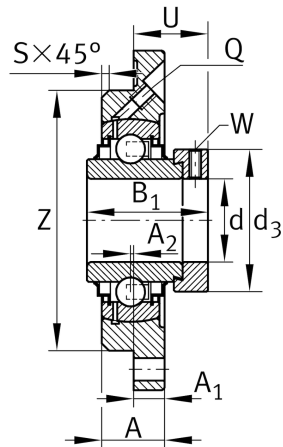
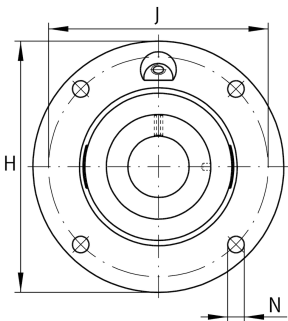

## Your current product variant

Groove	N	Cast iron housing with undercut slot for end caps
Material	GG	Grey cast iron

## Main Dimensions &amp; Performance Data

d	20 mm	Bore diameter
H	100 mm	Height flange
B <sub>1</sub>	43,7 mm	Locking collar total width
U	24,6 mm	Total height unit
C <sub>r</sub>	13.600 N	Basic dynamic load rating, radial
C <sub>0r</sub>	6.600 N	Basic static load rating, radial
C <sub>ur</sub>	345 N	Fatigue load limit, radial
≈m	0,57 kg	Weight

## Mounting dimensions

J	78 mm	Pitch circle diameter (holes)
N	9 mm	Fixing bore
Z	62 mm	Diameter spigot
	h8	Diameter spigot clearance
n	4	Number of screwing holes



### Dimensions

A	17 mm	Height housing
A <sub>1</sub>	8 mm	Thickness of flange
A <sub>2</sub>	2 mm	Distance raceway
S	2 mm	Chamfer width
Q	M6	Connection thread for lubrication

### Additional information

1	Number of housings
GG.ME04	Housing
GE20-XL-KRR-B	Bearing designation
KASK04	Protecting cap

### Temperature range

T <sub>min</sub>	-20 °C	Operating temperature min.
T <sub>max</sub>	120 °C	Operating temperature max.