

**RMEO50-XL**

Flanged housing unit

Housing units RMEO, four-bolt flanged housing units, cast iron, centring spigot, eccentric locking collar, series 63, R seals

X-life

Technical information

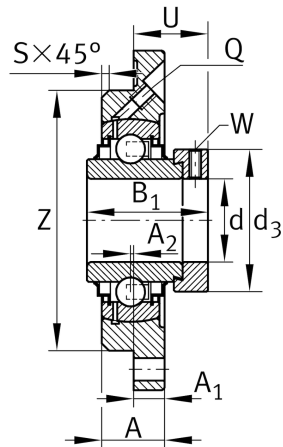
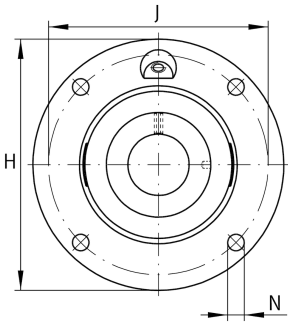

Your current product variant

Material	GG	Grey cast iron
----------	----	----------------

Main Dimensions & Performance Data

d	50 mm	Bore diameter
H	230 mm	Height flange
B ₁	66,75 mm	Locking collar total width
U	44,6 mm	Total height unit
C _r	62.000 N	Basic dynamic load rating, radial
C _{0r}	38.000 N	Basic static load rating, radial
C _{ur}	1.800 N	Fatigue load limit, radial
≈m	5,66 kg	Weight

Mounting dimensions

J	187 mm	Pitch circle diameter (holes)
N	23 mm	Fixing bore
Z	140 mm	Diameter spigot
	h8	Diameter spigot clearance
n	4	Number of screwing holes



Dimensions

A	31 mm	Height housing
A ₁	19 mm	Thickness of flange
A ₂	-2,5 mm	Distance raceway
S	2 mm	Chamfer width
Q	M6	Connection thread for lubrication

Additional information

1	Number of housings
MEO10	Housing
GNE50-XL-KRR-B	Bearing designation

Temperature range

T _{min}	-20 °C	Operating temperature min.
T _{max}	120 °C	Operating temperature max.