

**RME070-XL**

## Flanged housing unit

Housing units RMEO, four-bolt flanged housing units, cast iron, centring spigot, eccentric locking collar, series 63, R seals

X-life

## Technical information

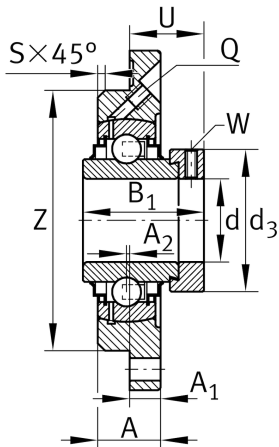
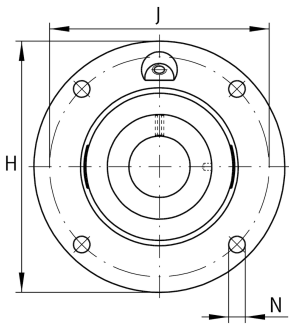

## Your current product variant

Material	GG	Grey cast iron
----------	----	----------------

## Main Dimensions &amp; Performance Data

d	70 mm	Bore diameter
H	300 mm	Height flange
B <sub>1</sub>	75,5 mm	Locking collar total width
U	49,9 mm	Total height unit
C <sub>r</sub>	104.000 N	Basic dynamic load rating, radial
C <sub>0r</sub>	68.000 N	Basic static load rating, radial
C <sub>ur</sub>	3.400 N	Fatigue load limit, radial
≈m	12,2 kg	Weight

## Mounting dimensions

J	252 mm	Pitch circle diameter (holes)
N	25 mm	Fixing bore
Z	185 mm	Diameter spigot
	h8	Diameter spigot clearance
n	4	Number of screwing holes



### Dimensions

A	43 mm	Height housing
A <sub>1</sub>	25 mm	Thickness of flange
A <sub>2</sub>	-0,5 mm	Distance raceway
S	4 mm	Chamfer width
Q	M6	Connection thread for lubrication

### Additional information

1	Number of housings
MEO14	Housing
GENE70-XL-KRR-B	Bearing designation

### Temperature range

T <sub>min</sub>	-20 °C	Operating temperature min.
T <sub>max</sub>	120 °C	Operating temperature max.