

IMAGE
COMING SOON**RME20-XL-N-FA101** [↗](#)

Flanged housing unit

Flanged housing unit RME...XL-N-FA101

X-life

Technical information

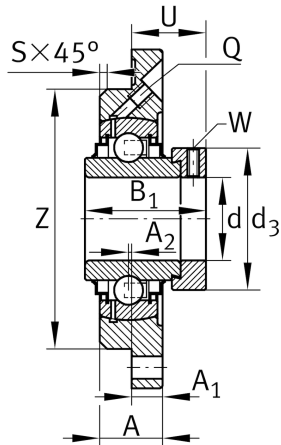
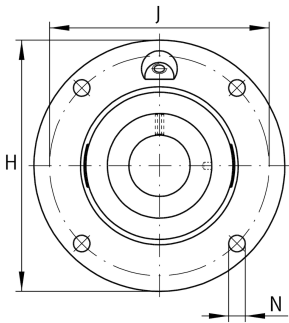

Your current product variant

Groove	N	Cast iron housing with undercut slot for end caps
Material	GG	Grey cast iron
Manufacturing instruction	FA101	High and low temperature design -40°C to +180°C

Main Dimensions & Performance Data

d	20 mm	Bore diameter
H	100 mm	Height flange
B ₁	43,7 mm	Locking collar total width
U	24,6 mm	Total height unit
C _r	12.800 N	Basic dynamic load rating, radial
C _{0r}	6.600 N	Basic static load rating, radial
≈m	0,56 kg	Weight

Mounting dimensions

J	78 mm	Pitch circle diameter (holes)
N	9 mm	Fixing bore
Z	62 mm	Diameter spigot
	h8	Diameter spigot clearance
W	3 mm	Width across flats
n	4	Number of screwing holes



Dimensions

A	17 mm	Height housing
A ₁	8 mm	Thickness of flange
A ₂	2 mm	Distance raceway
S	2 mm	Chamfer width
Q	M6	Connection thread for lubrication

Additional information

1	Number of housings
ME04-FA125	Housing
GE20-XL-KRR-B-FA101	Bearing designation
KASK04	Protecting cap

Temperature range

T _{min}	-40 °C	Operating temperature min.
T _{max}	180 °C	Operating temperature max.