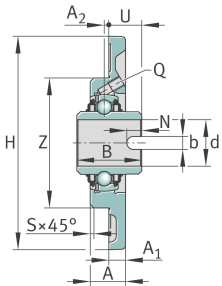
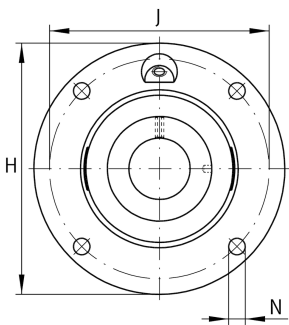

**RMEL50-N**

Flanged housing unit

Flanged housing unit RMEL..-N

## Technical information

**Your current product variant**

Groove	N	Cast iron housing with undercut slot for end caps
Material	GG	Grey cast iron

**Main Dimensions & Performance Data**

d	50 mm	Bore diameter
H	165 mm	Height flange
U	49,2 mm	Total height unit
C <sub>r</sub>	37.500 N	Basic dynamic load rating, radial
C <sub>0r</sub>	23.200 N	Basic static load rating, radial
C <sub>ur</sub>	1.210 N	Fatigue load limit, radial
≈m	2,129 kg	Weight

**Mounting dimensions**

J	135 mm	Pitch circle diameter (holes)
N	14 mm	Fixing bore
Z	110 mm	Diameter spigot
n	4	Number of screwing holes



### Dimensions

A	25 mm	Height housing
A <sub>1</sub>	13 mm	Thickness of flange
A <sub>2</sub>	1 mm	Distance raceway
B	49,2 mm	Width
Q	M8	Connection thread for lubrication

### Additional information

1	Number of housings
ME10-N	Housing
GLE50-XL-KRR-B	Bearing designation

### Temperature range

T <sub>min</sub>	-40 °C	Operating temperature min.
T <sub>max</sub>	180 °C	Operating temperature max.