

**RCJY20-XL-N**

## Flanged housing unit

Housing units RCJY, four-bolt flanged housing units, cast iron, grub screws in inner ring, R seals

X-life

## Technical information

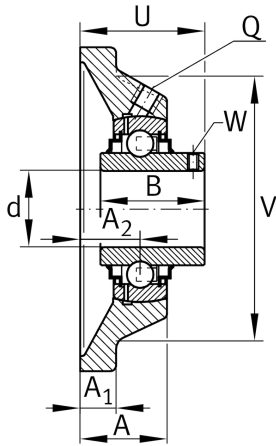
**Your current product variant**

Groove	N	Cast iron housing with undercut slot for end caps
Material	GG	Grey cast iron

**Main Dimensions & Performance Data**

d	20 mm	Bore diameter
L	86 mm	Flange width
U	37,3 mm	Total height unit
C <sub>r</sub>	13.600 N	Basic dynamic load rating, radial
C <sub>0r</sub>	6.600 N	Basic static load rating, radial
C <sub>ur</sub>	345 N	Fatigue load limit, radial
m	0,57 kg	Weight

**Mounting dimensions**

J	63,5 mm	Distance fixing bore
N	11,5 mm	Fixing bore
n	4	Number of screwing holes



### Dimensions

A	29 mm	Height housing
A <sub>1</sub>	10 mm	Thickness of flange
A <sub>2</sub>	19 mm	Distance raceway
B	31 mm	Width
V	68 mm	Shoulder diameter housing
Q	M6	Connection thread for lubrication

### Additional information

1	Number of housings
CJ04	Housing
GYE20-XL-KRR-B	Bearing designation
KASK04	Protecting cap

### Temperature range

T <sub>min</sub>	-20 °C	Operating temperature min.
T <sub>max</sub>	100 °C	Operating temperature max.