

**RCJO30-XL**

Flanged housing unit

Housing units RCJO, four-bolt flanged housing units, cast iron, eccentric locking collar, series 63, R seals

X-life

Technical information

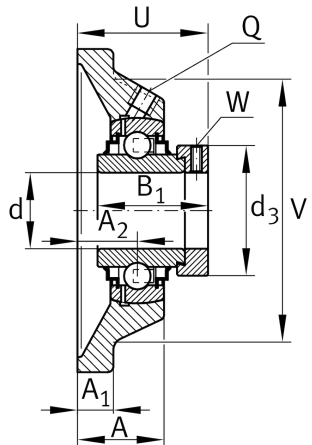
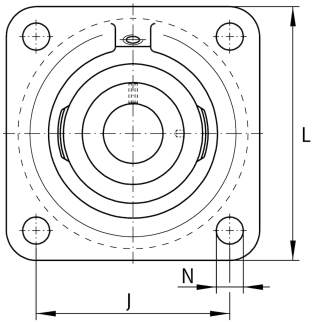

Your current product variant

Material	GG	Grey cast iron
----------	----	----------------

Main Dimensions & Performance Data

d	30 mm	Bore diameter
L	125 mm	Flange width
U	53,1 mm	Total height unit
C _r	31.500 N	Basic dynamic load rating, radial
C _{0r}	16.700 N	Basic static load rating, radial
C _{ur}	870 N	Fatigue load limit, radial
≈m	1,7 kg	Weight

Mounting dimensions

J	95 mm	Distance fixing bore
N	14,5 mm	Fixing bore
n	4	Number of screwing holes



Dimensions

A	30,6 mm	Height housing
A ₁	15 mm	Thickness of flange
A ₂	20,6 mm	Distance raceway
V	98 mm	Shoulder diameter housing
Q	M6	Connection thread for lubrication
d ₃	51 mm	Outside diameter locking device

Additional information

1	Number of housings
CJO06	Housing
GNE30-XL-KRR-B	Bearing designation

Temperature range

T _{min}	-20 °C	Operating temperature min.
T _{max}	120 °C	Operating temperature max.