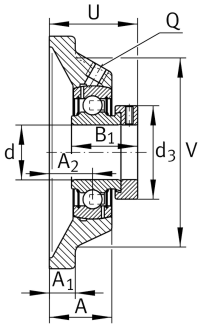
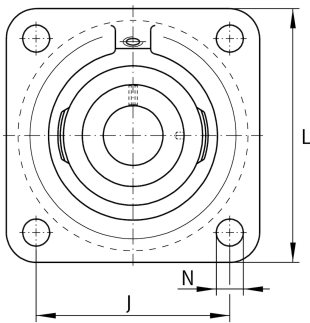

IMAGE  
COMING SOON**PCJ25-TV-FA125.5** [↗](#)

Flanged housing unit

Flanged housing unit PCJ...-TV

## Technical information

**Your current product variant**

Material	TV	Plastic
Manufacturing instruction	FA125.5	Bearing with Corroctect coating

**Main Dimensions & Performance Data**

d	25 mm	Bore diameter
L	94,5 mm	Flange width
U	40,5 mm	Total height unit
C <sub>r</sub>	13.700 N	Basic dynamic load rating, radial
C <sub>0r</sub>	7.100 N	Basic static load rating, radial
C <sub>0r G</sub>	12.100 N	Load carrying capacity (housing)
≈m	0,39 kg	Weight

**Mounting dimensions**

J	70 mm	Distance fixing bore
N	11 mm	Fixing bore
n	4	Number of screwing holes



### Dimensions

A	27,9 mm	Height housing
A <sub>1</sub>	14,3 mm	Thickness of flange
A <sub>2</sub>	17 mm	Distance raceway
V	70 mm	Shoulder diameter housing
Q	1/4-28 UNF	Connection thread for lubrication
d <sub>3</sub>	37,5 mm	Outside diameter locking device

### Additional information

1	Number of housings
GEH.CJ05-TV-HLA	Housing
GRAE25-NPP-B-FA107/125.5	Bearing designation
KASK05	Protecting cap

### Temperature range

T <sub>min</sub>	-35 °C	Operating temperature min.
T <sub>max</sub>	100 °C	Operating temperature max.